

CABLE TRAYS

KBSTI

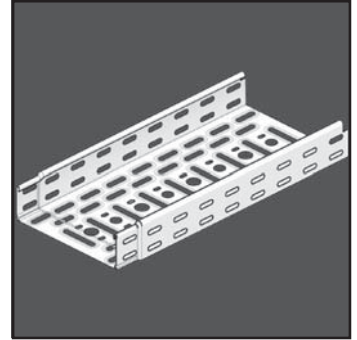

KBSI



KBS

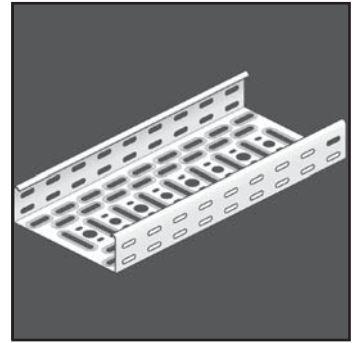

KGI / KG



NATO

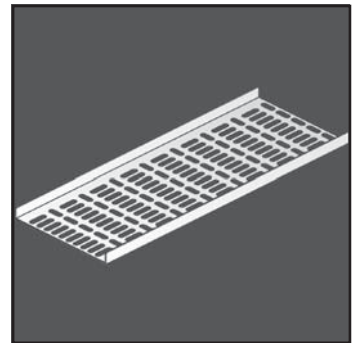

CABLE TRAYS

KBSTI

	Survey of the system	1-7
KBSTI		
KBSTI 60	Cable tray snap-in	1-8
COVER		
D	Universal cover	1-9
COVER CLAMPS		
DCLTI	Lid clamp clips KBSTI	1-9
BRACKETS		
CCLTI	Bracket KBSTI for wall and ceiling	1-10
ACCESSORIES		
BTI	Horizontal bend 90° KBSTI	1-11
DBTI	Cover for horizontal bend 90° KBSTI	1-11
VHTI	Adjustable Corner KBSTI	1-12
DVHTI	Cover VHTI	1-12
TTI	Horizontal T-piece KBSTI	1-13
DT	Cover for horizontal T-piece	1-13
ASTI	Horizontal adapter 90° KBSTI	1-14
DAS	Cover for horizontal adapter 90°	1-14
KRTI	Cross-over KBSTI	1-15
DKR	Cover for cross-over	1-15
SBTI	Rising elbow 90° KBSTI	1-16
DSBTI	Cover for rising elbow 90° KBSTI	1-16
VBTI	Low elbow 90° KBSTI	1-17
DVBTI	Cover for low elbow 90° KBSTI	1-17
SDBTI	Hinged joint double KBSTI	1-18
DSTI	Hinged joint KBSTI	1-18
AZHTI	Universal coupling 90° KBSTI	1-18
VSTI	Reducing plate KBSTI	1-19
ETI	End piece KBSTI	1-19
MOUNTING PLATES		
MPV	Flat mounting plate	1-20
MPVCL	Mounting plate clips	1-20
SEPERATORS		
SLOS	Division plate free	1-21
SLIS	Clip-in partition	1-21
CL	Clips for clip-in partition	1-22
	TECHNICAL INFORMATION	1-23

CABLE TRAYS

	Survey of the system	1-33
KBSI		
KBSI 35	Cable tray with interlocking ends	1-34
KBSI 60	Cable tray with interlocking ends	1-35
KBSI 60*6	Cable tray with interlocking ends	1-36
KBS		
KBS 35	Perforated cable tray	1-37
KBS 60	Perforated cable tray	1-38
KBS 85	Perforated cable tray	1-39
KBS 110	Perforated cable tray	1-40
KBS 110*6	Perforated cable tray	1-41
KGI		
KGI 60	Cable tray not perforated, interlocking	1-42
KG		
KG 110	Cable tray not perforated	1-43
NATO		
NATO 15	Perforated cable tray - upright flanges	1-44
COVER		
D	Universal cover	1-45
COVER CLAMPS		

DCO	Lid clamp	1-46
DCL	Lid clamp clips	1-46
ACCESSORIES		
B 90	Horizontal bend 90°	1-47
DB 90	Cover for horizontal bend 90°	1-48
VH	Adjustable Corner 90-180°	1-49
T	Horizontal T-piece	1-50
DT	Cover for horizontal T-piece	1-51
AS	Horizontal adapter 90°	1-52
DAS	Cover for horizontal adapter 90°	1-53
KR	Cross-over	1-54
DKR	Cover for cross-over	1-55
SB 90	Rising elbow 90°	1-56
SBCL	Snap-in internal rising bend 90°	1-57
DSB 90	Cover for rising elbow 90°	1-57
VB 90	Low elbow 90°	1-58
VBCL	Snap-in external rising bend	1-59
DVB 90	Cover for low elbow 90°	1-59
SDB	Hinged joint double	1-60
DS	Hinged joint	1-60
AZH	Universal coupling 90°	1-61
BVSI	Stiffening plate	1-61
VS	Reducing plate	1-62
E	End piece	1-63
MOUNTING PLATES		
MP	Folded mounting plate	1-64
MPV	Flat mounting plate	1-64
MPVCL	Mounting plate clips	1-65
SEPERATORS		
SLOS	Division plate free	1-66
SLIS	Clip-in partition	1-66
CL	Clips for clip-in partition	1-67
SIN	Build-in division plate	1-67
JOINTING PLATE		
V 35	Jointing plate for fast mounting	1-68
V 60	Jointing plate for fast mounting	1-68
V 85	Jointing plate for fast mounting	1-68
V 15*200	Jointing plate	1-69
V 35*200	Jointing plate	1-69
V 60*200	Jointing plate	1-69
V 85*200	Jointing plate	1-70
V 110*200	Jointing plate	1-70
KPW	Jointing plate for wide-span	1-70
LV	Supporting corner	1-71
KBV	Fast locking for KBSI	1-71
	TECHNICAL INFORMATION	1-72

CABLE TRAYS

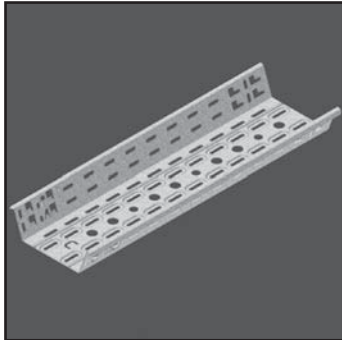

KBSTI

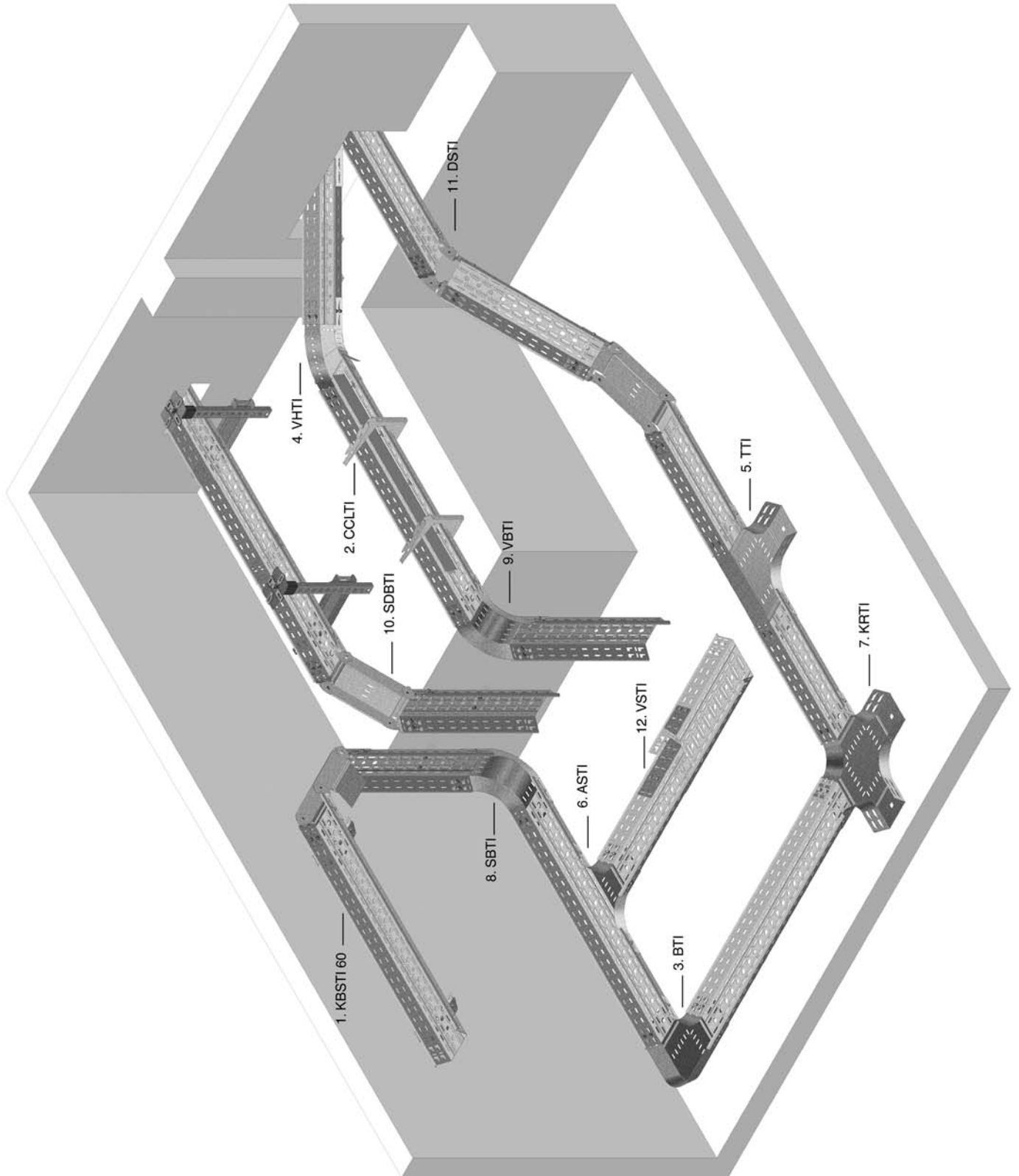

Survey of the system

	Description	Reference	Pag.
1	Cable tray snap-in	KBSTI 60	1-8
2	Bracket KBSTI for wall and ceiling	CCLTI	1-10
3	Horizontal bend 90° KBSTI	BTI	1-11
4	Adjustable Corner KBSTI	VHTI	1-12
5	Horizontal T-piece KBSTI	TTI	1-13
6	Horizontal adapter 90° KBSTI	ASTI	1-14
7	Cross-over KBSTI	KRTI	1-15
8	Rising elbow 90° KBSTI	SBTI	1-16
9	Low elbow 90° KBSTI	VBTI	1-17
10	Hinged joint double KBSTI	SDBTI	1-18
11	Hinged joint KBSTI	DSTI	1-18
12	Reducing plate KBSTI	VSTI	1-19

KBSTI 60

Cable tray snap-in

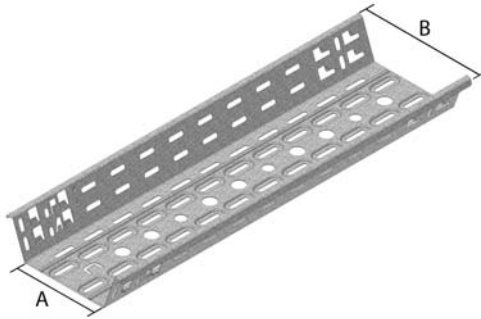

Taper-shape
 Optimally stackable
 Snap-in
 Random overlap

A	85	135	185	235	335
B	151	201	251	301	401

On Demand	Gauge 1,25 mm
On Demand	Powder coating / Duplex System
Standard finish	Pre-galvanised
Optional finish 1	Hot-dip galvanised

1		Reference	Height	Width	Thickness	Length	kg/m	Packaging	Stock	Unit			
HD	-	KBSTI 60*150*0.60	60	150	0,60	3000	1,166	30	✓	m			
HD	-	KBSTI 60*150*0.75	60	150	0,75	3000	1,540	30	✓	m			
-	-	KBSTI 60*150*1.00	60	150	1,00	3000	1,960	30	✓	m			
HD	-	KBSTI 60*200*0.60	60	200	0,60	3000	1,409	30	✓	m			
HD	-	KBSTI 60*200*0.75	60	200	0,75	3000	1,760	30	✓	m			
-	-	KBSTI 60*200*1.00	60	200	1,00	3000	2,349	30	✓	m			
HD	-	KBSTI 60*250*0.60	60	250	0,60	3000	1,652	30	✓	m			
HD	-	KBSTI 60*250*0.75	60	250	0,75	3000	2,066	30	✓	m			
-	-	KBSTI 60*250*1.00	60	250	1,00	3000	2,754	30	✓	m			
HD	-	KBSTI 60*300*0.75	60	300	0,75	3000	2,369	30	✓	m			
-	-	KBSTI 60*300*1.00	60	300	1,00	3000	3,159	30	✓	m			
HD	-	KBSTI 60*400*0.75	60	400	0,75	3000	2,390	30	✓	m			
-	-	KBSTI 60*400*1.00	60	400	1,00	3000	3,969	30	✓	m			

More technical specifications for this product can be found at the end of this chapter.

CHARACTERISTICS

The patented and clickable KBSTI cable tray system is designed to be stronger, optimally stackable and transportable, quick to install, with random overlap and exceedingly safe.

Embedded perforations for :

- extra load capacity
- better aeration
- better stability
- better condensation drainage

Alternative perforations for :

- better fixation on the supports
- very useful for cable fixation.

Earthing. Certificate on electrical continuity is available.

TECHNICAL INFORMATION

The perforation scheme differs according to the width.

The surface of the interlocking end is rounded in order to protect the cables.

Provide for an opening for the fitting of a gland, a round hole with

- Ø 16 mm for PG 11
- Ø 19,5 mm for PG 13,5

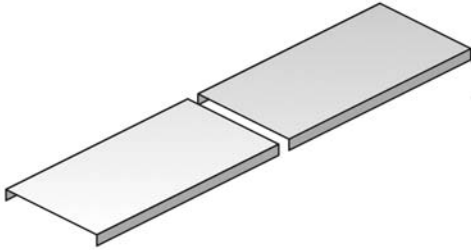
Accessories
D
Universal cover

Especially used for horizontal en vertical sections.
Cover with board height 10 mm.

On Demand	Powder coating / Duplex System
Standard finish	Pre-galvanised
Optional finish 1	Hot-dip galvanised

1		Reference	Height	Width	Thickness	Length	kg/m	Packaging	Stock	Unit			
HD	-	D 150	-	150	-	2000	1,170	10	✓	m			
HD	-	D 200	-	200	-	2000	1,420	10	✓	m			
HD	-	D 250	-	250	-	2000	1,850	10	✓	m			
HD	-	D 300	-	300	-	2000	2,100	10	✓	m			
HD	-	D 400	-	400	-	2000	4,150	10	✓	m			

To fix with:

-	-	DCLTI	-	-	-	-	0,004	100	✓	piece			
---	---	-------	---	---	---	---	-------	-----	---	-------	--	--	--

DCLTI
Lid clamp clips KBSTI



	Standard finish	Stainless Steel
--	-----------------	-----------------

1		Reference	Height	Width	Thickness	Length	kg/piece	Packaging	Stock	Unit			
-	-	DCLTI	-	-	-	-	0,004	100	✓	piece			

More technical specifications for this product can be found at the end of this chapter.

CCLTI

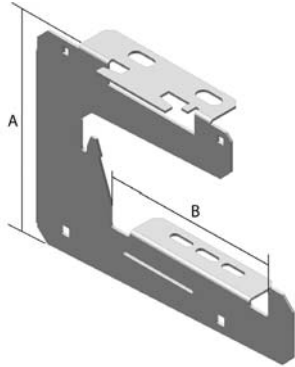
Bracket KBSTI for wall and ceiling



Ideal for installations in low ceiling.
Also applicable for KBSI, KBS, KGI, KG.

Width	Max. load (daN) (wall)	Max. load (daN) (ceiling)	A	B
150	107	63	179	103
200	80	47	181	153
250	150	110	184	203
300	133	83	190	253
400	100	62	188	353

On Demand	Powder coating / Duplex System
Standard finish	Pre-galvanised
Optional finish 1	Hot-dip galvanised

1	Reference	Height	Width	Thickness	Length	kg/piece	Packaging	Stock	Unit
HD	- CCLTI 150	-	150	-	-	0,457	1	✓	piece
HD	- CCLTI 200	-	200	-	-	0,507	1	✓	piece
HD	- CCLTI 250	-	250	-	-	0,781	1	✓	piece
HD	- CCLTI 300	-	300	-	-	1,105	1	✓	piece
HD	- CCLTI 400	-	400	-	-	1,395	1	✓	piece

More technical specifications for this product can be found at the end of this chapter.

Multiple brackets can be mounted one below another.

Accessories

BTI

Horizontal bend 90° KBSTI



Width	150	200	250	300	400
A	84	134	184	234	334
B	130	180	230	280	380

On Demand	Powder coating / Duplex System
Standard finish	Pre-galvanised
Optional finish 1	Hot-dip galvanised

1		Reference	Height	Width	Thickness	Length	kg/piece	Packaging	Stock	Unit			
HD	-	BTI 90*60*150	60	150	-	-	0,632	1	✓	piece			
HD	-	BTI 90*60*200	60	200	-	-	0,880	1	✓	piece			
HD	-	BTI 90*60*250	60	250	-	-	1,154	1	✓	piece			
HD	-	BTI 90*60*300	60	300	-	-	1,460	1	✓	piece			
HD	-	BTI 90*60*400	60	400	-	-	2,178	1	✓	piece			

More technical specifications for this product can be found at the end of this chapter.

DBTI

Cover for horizontal bend 90° KBSTI



On Demand	Powder coating / Duplex System
Standard finish	Pre-galvanised
Optional finish 1	Hot-dip galvanised

1		Reference	Height	Width	Thickness	Length	kg/piece	Packaging	Stock	Unit			
HD	-	DBTI 90*150	-	150	-	-	0,320	1	✓	piece			
HD	-	DBTI 90*200	-	200	-	-	0,460	1	✓	piece			
HD	-	DBTI 90*250	-	250	-	-	0,620	1	✓	piece			
HD	-	DBTI 90*300	-	300	-	-	0,798	1	✓	piece			
HD	-	DBTI 90*400	-	400	-	-	1,220	1	✓	piece			

To fix with:

1		Reference	Height	Width	Thickness	Length	kg/piece	Packaging	Stock	Unit			
-	-	DCLTI	-	-	-	-	0,004	100	✓	piece			

VHTI

Adjustable Corner KBSTI

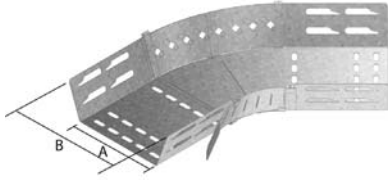

Width	150	200	250	300	400
A	86	136	186	236	336
B	129	179	229	279	379

On Demand	Powder coating / Duplex System
Standard finish	Pre-galvanised
Optional finish 1	Hot-dip galvanised

1	Reference	Height	Width	Thickness	Length	kg/piece	Packaging	Stock	Unit
HD	- VHTI 60*150	60	150	-	-	0,558	1	✓	piece
HD	- VHTI 60*200	60	200	-	-	0,761	1	✓	piece
HD	- VHTI 60*250	60	250	-	-	0,986	1	✓	piece
HD	- VHTI 60*300	60	300	-	-	1,235	1	✓	piece
HD	- VHTI 60*400	60	400	-	-	1,773	1	✓	piece

More technical specifications for this product can be found at the end of this chapter.

DVHTI

Cover VHTI



On Demand	Powder coating / Duplex System
Standard finish	Pre-galvanised
Optional finish 1	Hot-dip galvanised

1	Reference	Height	Width	Thickness	Length	kg/piece	Packaging	Stock	Unit
HD	- DVHTI 150	-	150	-	-	0,315	1	✓	piece
HD	- DVHTI 200	-	200	-	-	0,446	1	✓	piece
HD	- DVHTI 250	-	250	-	-	0,589	1	✓	piece
HD	- DVHTI 300	-	300	-	-	0,752	1	✓	piece
HD	- DVHTI 400	-	400	-	-	1,100	1	✓	piece

To fix with:									
-	-	DCLTI	-	-	-	0,004	100	✓	piece

Accessories

TTI

Horizontal T-piece KBSTI

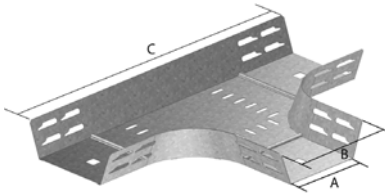

Width	150	200	250	300	400
A	84	134	184	234	334
B	130	180	230	280	380
C	507	557	607	657	757

On Demand	Powder coating / Duplex System
Standard finish	Pre-galvanised
Optional finish 1	Hot-dip galvanised

1		Reference	Height	Width	Thickness	Length	kg/piece	Packaging	Stock	Unit			
HD	-	TTI 60*150	60	150	-	-	0,878	1	✓	piece			
HD	-	TTI 60*200	60	200	-	-	1,168	1	✓	piece			
HD	-	TTI 60*250	60	250	-	-	1,484	1	✓	piece			
HD	-	TTI 60*300	60	300	-	-	1,834	1	✓	piece			
HD	-	TTI 60*400	60	400	-	-	2,624	1	✓	piece			

DT

Cover for horizontal T-piece

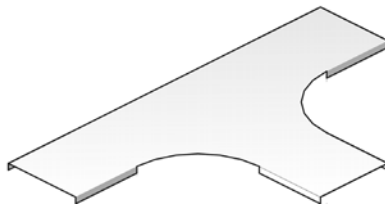

On Demand	Powder coating / Duplex System
Standard finish	Pre-galvanised
Optional finish 1	Hot-dip galvanised

1		Reference	Height	Width	Thickness	Length	kg/piece	Packaging	Stock	Unit			
HD	-	DT 150	-	150	-	-	0,910	1	✓	piece			
HD	-	DT 200	-	200	-	-	1,270	1	✓	piece			
HD	-	DT 250	-	250	-	-	1,780	1	✓	piece			
HD	-	DT 300	-	300	-	-	2,160	1	✓	piece			
HD	-	DT 400	-	400	-	-	2,950	1	✓	piece			

To fix with:

-	-	DCLTI	-	-	-	-	0,004	100	✓	piece			
---	---	-------	---	---	---	---	-------	-----	---	-------	--	--	--

ASTI

Horizontal adapter 90° KBSTI



Width	150	200	250	300	400
A	84	134	184	234	334
B	130	180	230	280	380

On Demand	Powder coating / Duplex System
Standard finish	Pre-galvanised
Optional finish 1	Hot-dip galvanised

1		Reference	Height	Width	Thickness	Length	kg/piece	Packaging	Stock	Unit			
HD	-	ASTI 60*150	60	150	-	-	0,448	1	✓	piece			
HD	-	ASTI 60*200	60	200	-	-	0,513	1	✓	piece			
HD	-	ASTI 60*250	60	250	-	-	0,583	1	✓	piece			
HD	-	ASTI 60*300	60	300	-	-	0,650	1	✓	piece			
HD	-	ASTI 60*400	60	400	-	-	0,794	1	✓	piece			

DAS

Cover for horizontal adapter 90°

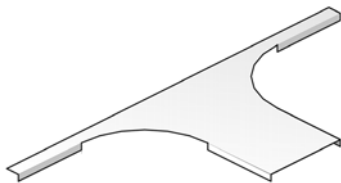

On Demand	Powder coating / Duplex System
Standard finish	Pre-galvanised
Optional finish 1	Hot-dip galvanised

1		Reference	Height	Width	Thickness	Length	kg/piece	Packaging	Stock	Unit			
HD	-	DAS 150	-	150	-	-	0,360	1	✓	piece			
HD	-	DAS 200	-	200	-	-	0,400	1	✓	piece			
HD	-	DAS 250	-	250	-	-	0,550	1	✓	piece			
HD	-	DAS 300	-	300	-	-	0,680	1	✓	piece			
HD	-	DAS 400	-	400	-	-	0,750	1	✓	piece			

To fix with:

-	-	DCLTI	-	-	-	-	0,004	100	✓	piece			
---	---	-------	---	---	---	---	-------	-----	---	-------	--	--	--

Accessories

KRTI

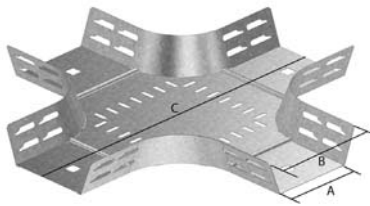
Cross-over KBSTI

Width	150	200	250	300	400
A	84	134	184	234	334
B	130	180	230	280	380
C	506	556	606	656	756

On Demand	Powder coating / Duplex System
Standard finish	Pre-galvanised
Optional finish 1	Hot-dip galvanised

1		Reference	Height	Width	Thickness	Length	kg/piece	Packaging	Stock	Unit			
HD	-	KRTI 60*150	60	150	-	-	1,080	1	✓	piece			
HD	-	KRTI 60*200	60	200	-	-	1,410	1	✓	piece			
HD	-	KRTI 60*250	60	250	-	-	1,775	1	✓	piece			
HD	-	KRTI 60*300	60	300	-	-	2,160	1	✓	piece			
HD	-	KRTI 60*400	60	400	-	-	3,040	1	✓	piece			

DKR

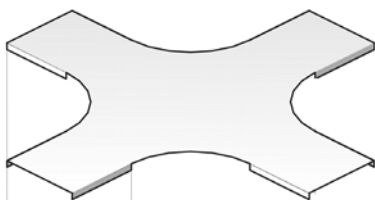
Cover for cross-over

On Demand	Powder coating / Duplex System
Standard finish	Pre-galvanised
Optional finish 1	Hot-dip galvanised

1		Reference	Height	Width	Thickness	Length	kg/piece	Packaging	Stock	Unit			
HD	-	DKR 150	-	150	-	-	1,160	1	✓	piece			
HD	-	DKR 200	-	200	-	-	1,590	1	✓	piece			
HD	-	DKR 250	-	250	-	-	2,020	1	✓	piece			
HD	-	DKR 300	-	300	-	-	2,480	1	✓	piece			
HD	-	DKR 400	-	400	-	-	5,000	1	✓	piece			

To fix with:

-	-	DCLTI	-	-	-	-	0,004	100	✓	piece			
---	---	-------	---	---	---	---	-------	-----	---	-------	--	--	--

SBTI

Rising elbow 90° KBSTI



Width	150	200	250	300	400
A	85	135	185	235	335
B	131	181	231	281	381

On Demand	Powder coating / Duplex System
Standard finish	Pre-galvanised
Optional finish 1	Hot-dip galvanised

1		Reference	Height	Width	Thickness	Length	kg/piece	Packaging	Stock	Unit			
HD	-	SBTI 90°60°150	60	150	-	-	0,575	1	✓	piece			
HD	-	SBTI 90°60°200	60	200	-	-	0,713	1	✓	piece			
HD	-	SBTI 90°60°250	60	250	-	-	0,855	1	✓	piece			
HD	-	SBTI 90°60°300	60	300	-	-	0,993	1	✓	piece			
HD	-	SBTI 90°60°400	60	400	-	-	1,274	1	✓	piece			

DSBTI

Cover for rising elbow 90° KBSTI

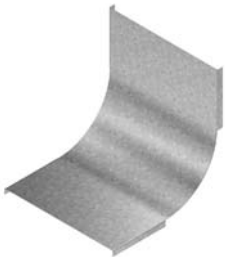

On Demand	Powder coating / Duplex System
Standard finish	Pre-galvanised
Optional finish 1	Hot-dip galvanised

1		Reference	Height	Width	Thickness	Length	kg/piece	Packaging	Stock	Unit			
HD	-	DSBTI 90°150	-	150	-	-	0,222	1	✓	piece			
HD	-	DSBTI 90°200	-	200	-	-	0,293	1	✓	piece			
HD	-	DSBTI 90°250	-	250	-	-	0,356	1	✓	piece			
HD	-	DSBTI 90°300	-	300	-	-	0,425	1	✓	piece			
HD	-	DSBTI 90°400	-	400	-	-	0,560	1	✓	piece			

To fix with:

-	-	DCLTI	-	-	-	-	0,004	100	✓	piece			
---	---	-------	---	---	---	---	-------	-----	---	-------	--	--	--

Accessories

VBTI

Low elbow 90° KBSTI

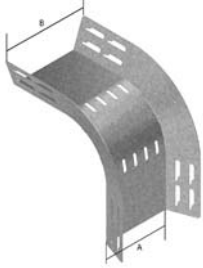

Width	150	200	250	300	400
A	84	134	184	234	334
B	130	180	230	280	380

On Demand	Powder coating / Duplex System
Standard finish	Pre-galvanised
Optional finish 1	Hot-dip galvanised

1		Reference	Height	Width	Thickness	Length	kg/piece	Packaging	Stock	Unit			
HD	-	VBTI 90°60°150	60	150	-	-	0,531	1	✓	piece			
HD	-	VBTI 90°60°200	60	200	-	-	0,648	1	✓	piece			
HD	-	VBTI 90°60°250	60	250	-	-	0,765	1	✓	piece			
HD	-	VBTI 90°60°300	60	300	-	-	0,878	1	✓	piece			
HD	-	VBTI 90°60°400	60	400	-	-	1,107	1	✓	piece			

DVBTI

Cover for low elbow 90° KBSTI

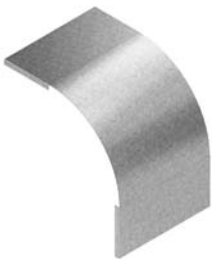

On Demand	Powder coating / Duplex System
Standard finish	Pre-galvanised
Optional finish 1	Hot-dip galvanised

1		Reference	Height	Width	Thickness	Length	kg/piece	Packaging	Stock	Unit			
HD	-	DVBTI 90°60°150	60	150	-	-	0,279	1	✓	piece			
HD	-	DVBTI 90°60°200	60	200	-	-	0,365	1	✓	piece			
HD	-	DVBTI 90°60°250	60	250	-	-	0,448	1	✓	piece			
HD	-	DVBTI 90°60°300	60	300	-	-	0,533	1	✓	piece			
HD	-	DVBTI 90°60°400	60	400	-	-	0,708	1	✓	piece			

To fix with:

-	-	DCLTI	-	-	-	-	0,004	100	✓	piece			
---	---	-------	---	---	---	---	-------	-----	---	-------	--	--	--

SDBTI

Hinged joint double KBSTI



On Demand	Powder coating / Duplex System
Standard finish	Pre-galvanised
Optional finish 1	Hot-dip galvanised

1		Reference	Height	Width	Thickness	Length	kg/piece	Packaging	Stock	Unit			
HD	-	SDBTI 60*150	60	150	-	-	0,866	1	-	piece			
HD	-	SDBTI 60*200	60	200	-	-	1,011	1	-	piece			
HD	-	SDBTI 60*250	60	250	-	-	1,157	1	-	piece			
HD	-	SDBTI 60*300	60	300	-	-	1,245	1	-	piece			
HD	-	SDBTI 60*400	60	400	-	-	1,600	1	-	piece			

More technical specifications for this product can be found at the end of this chapter.

DSTI

Hinged joint KBSTI



On Demand	Powder coating / Duplex System
Standard finish	Pre-galvanised
Optional finish 1	Hot-dip galvanised

1		Reference	Height	Width	Thickness	Length	kg/piece	Packaging	Stock	Unit			
HD	-	DSTI 60	60	-	-	-	0,130	50	✓	piece			

AZHTI

Universal coupling 90° KBSTI



On Demand	Powder coating / Duplex System
Standard finish	Pre-galvanised
Optional finish 1	Hot-dip galvanised

1		Reference	Height	Width	Thickness	Length	kg/piece	Packaging	Stock	Unit			
HD	-	AZHTI 60	60	-	-	-	0,190	1	✓	piece			

Accessories

VSTI

Reducing plate KBSTI



On Demand	Powder coating / Duplex System
Standard finish	Pre-galvanised
Optional finish 1	Hot-dip galvanised

1		Reference	Height	Width	Thickness	Length	kg/piece	Packaging	Stock	Unit			
HD	-	VSTI 60	60	-	-	-	0,136	1	✓	piece			

ETI

End piece KBSTI



Flat banded

On Demand	Powder coating / Duplex System
Standard finish	Pre-galvanised
Optional finish 1	Hot-dip galvanised

1		Reference	Height	Width	Thickness	Length	kg/piece	Packaging	Stock	Unit			
HD	-	ETI 60	60	-	-	-	0,120	1	✓	piece			

MPV

Flat mounting plate

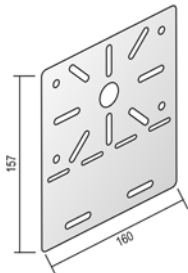

On Demand	Powder coating / Duplex System
Standard finish	Pre-galvanised
Optional finish 1	Hot-dip galvanised

1	Reference	Height	Width	Thickness	Length	kg/piece	Packaging	Stock	Unit
HD	- MPV	-	-	-	-	0,200	50	✓	piece
To fix with:									
HD	- VM 6*10	-	-	M6	10	0,010	250	✓	piece
-	- KBV	-	-	-	-	0,010	96	✓	piece
HD	- VMK 6*10	-	-	M6	-	0,010	250	✓	piece

For the fixation of contact and distribution boxes.
Number bolts and nuts VM 6*10: 2 pieces.

MPVCL

Mounting plate clips

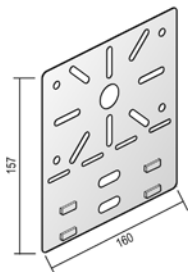

Standard finish	Pre-galvanised
-----------------	----------------

1	Reference	Height	Width	Thickness	Length	kg/piece	Packaging	Stock	Unit
-	- MPVCL	-	-	-	-	0,180	50	✓	piece
To fix with:									
-	- KBV	-	-	-	-	0,010	96	✓	piece

For the fixation of contact and distribution boxes.

Accessories

SLOS

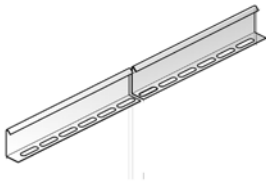
Division plate free

On Demand	Powder coating / Duplex System
Standard finish	Pre-galvanised
Optional finish 1	Hot-dip galvanised

1		Reference	Height	Width	Thickness	Length	kg/m	Packaging	Stock	Unit			
HD	-	SLOS 60	60	-	-	3000	0,510	120	✓	m			

To fix with:

HD	-	VM 6*10	-	-	M6	10	0,010	250	✓	piece			
HD	-	VMK 6*10	-	-	M6	-	0,010	250	✓	piece			

Fixation set VM 6*10: 1 per meter.

SLIS

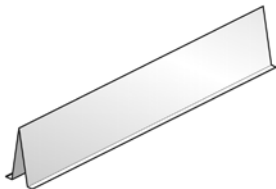
Clip-in partition

Standard finish	Pre-galvanised
-----------------	----------------

1		Reference	Height	Width	Thickness	Length	kg/m	Packaging	Stock	Unit			
-	-	SLIS 60	60	-	-	3000	0,440	3	✓	m			

Fixation set clips CL : 4 pieces per length.
Separation SLIS can be used on any width from 200 mm.

CL

Clips for clip-in partition

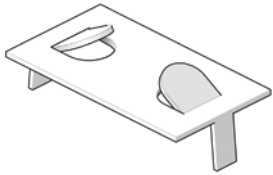

		Standard finish						Pre-galvanised					
1		Reference	Height	Width	Thickness	Length	kg/piece	Packaging	Stock	Unit			
-	-	CL	-	-	-	-	0,005	100	✓	piece			

4 pieces per length

KBSTI 60

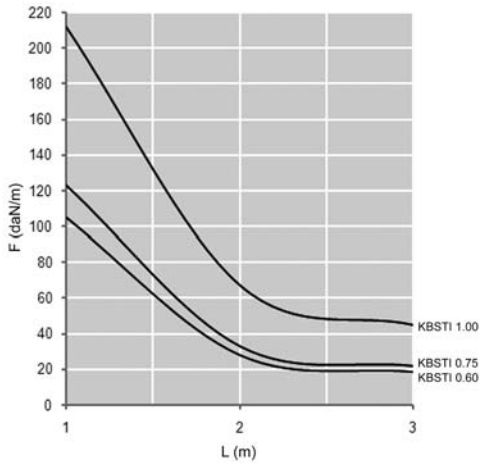

LOAD DIAGRAM

Graph valid for KBSTI 60. This diagram illustrates the permissible uniformly distributed loads applied to multiple supports. They comply with IEC 61537 par 10.3.3 test type III with connection to 1/5 of the span.

F = max. admissible load (daN/m)

L = support distance (m)

Max. deflection (m) = $L/100$

For higher load capacity of the KBSTI 60, please consult our sales team.

KBSTI 60

Mounting principle

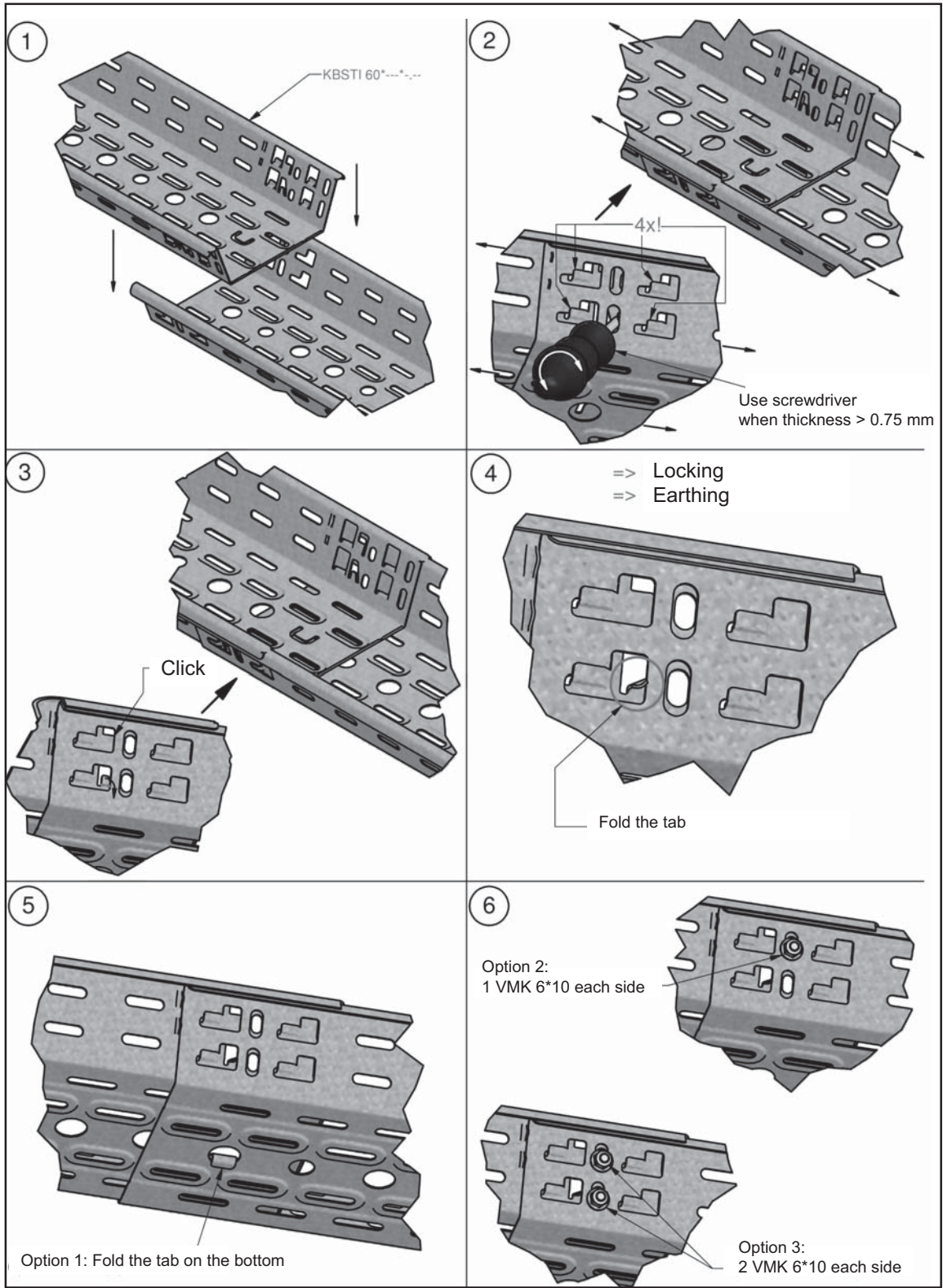

DCLTI

Mounting principle

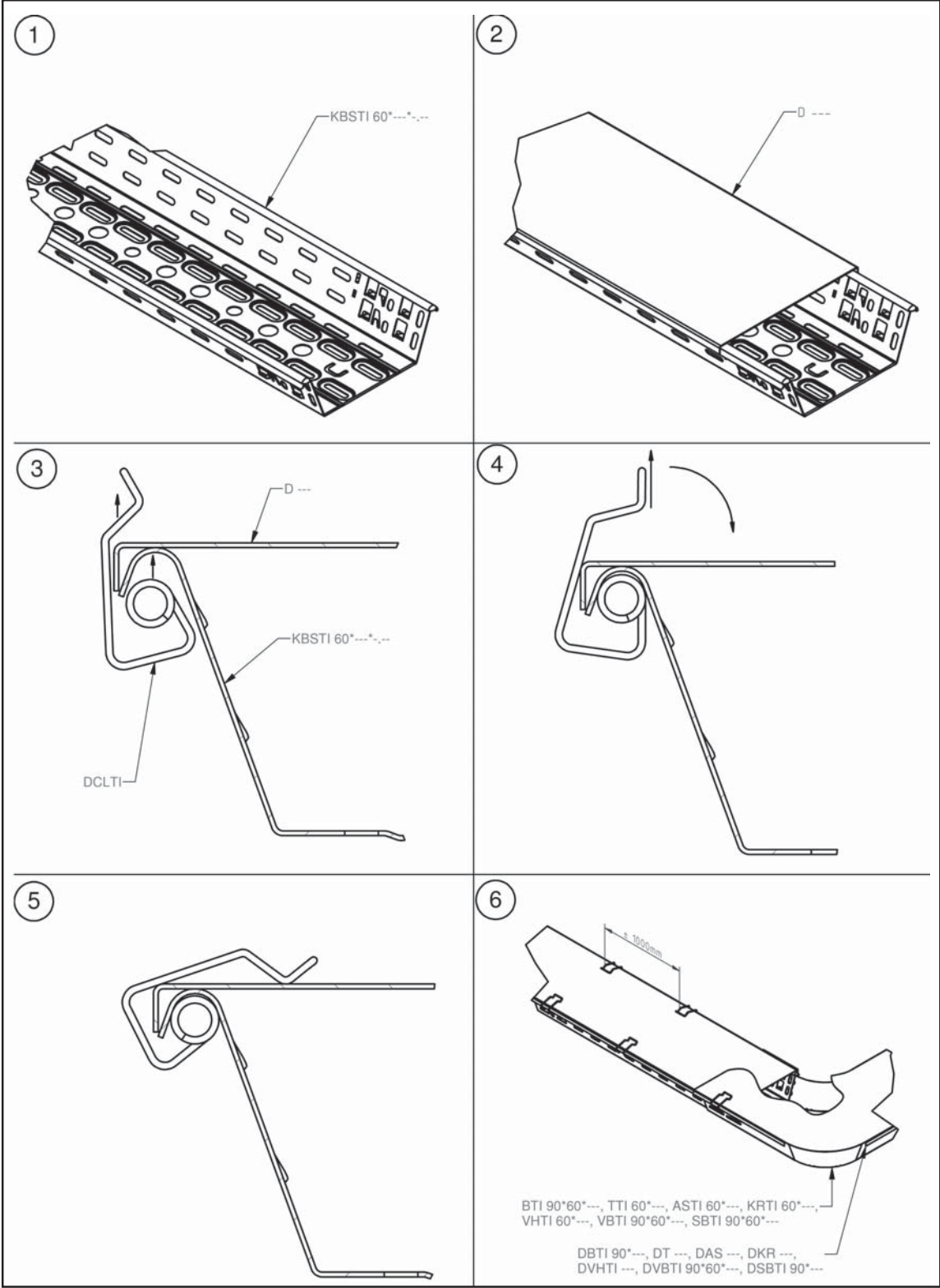

CCLTI

Mounting principle

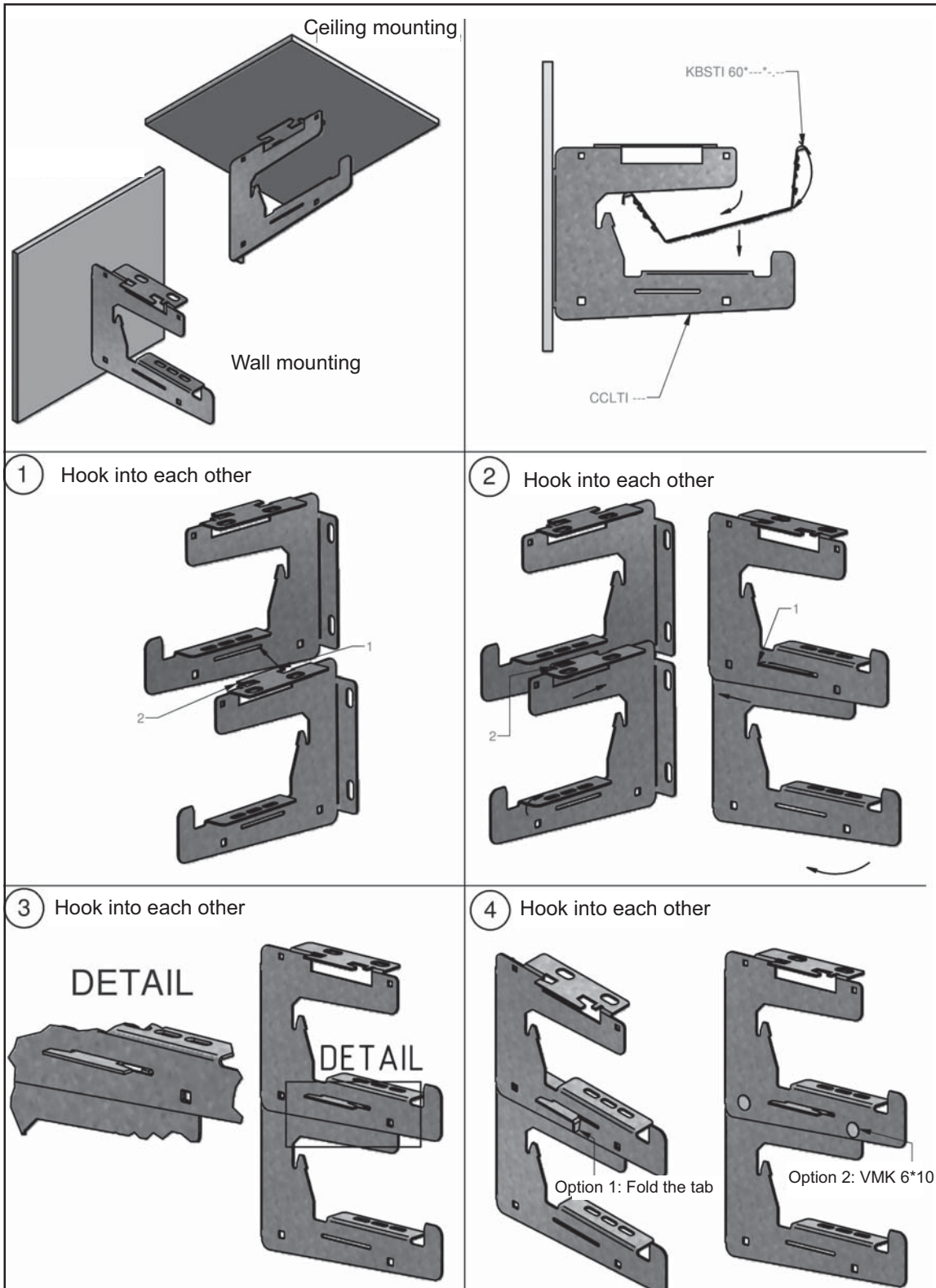

BTI

Mounting principle

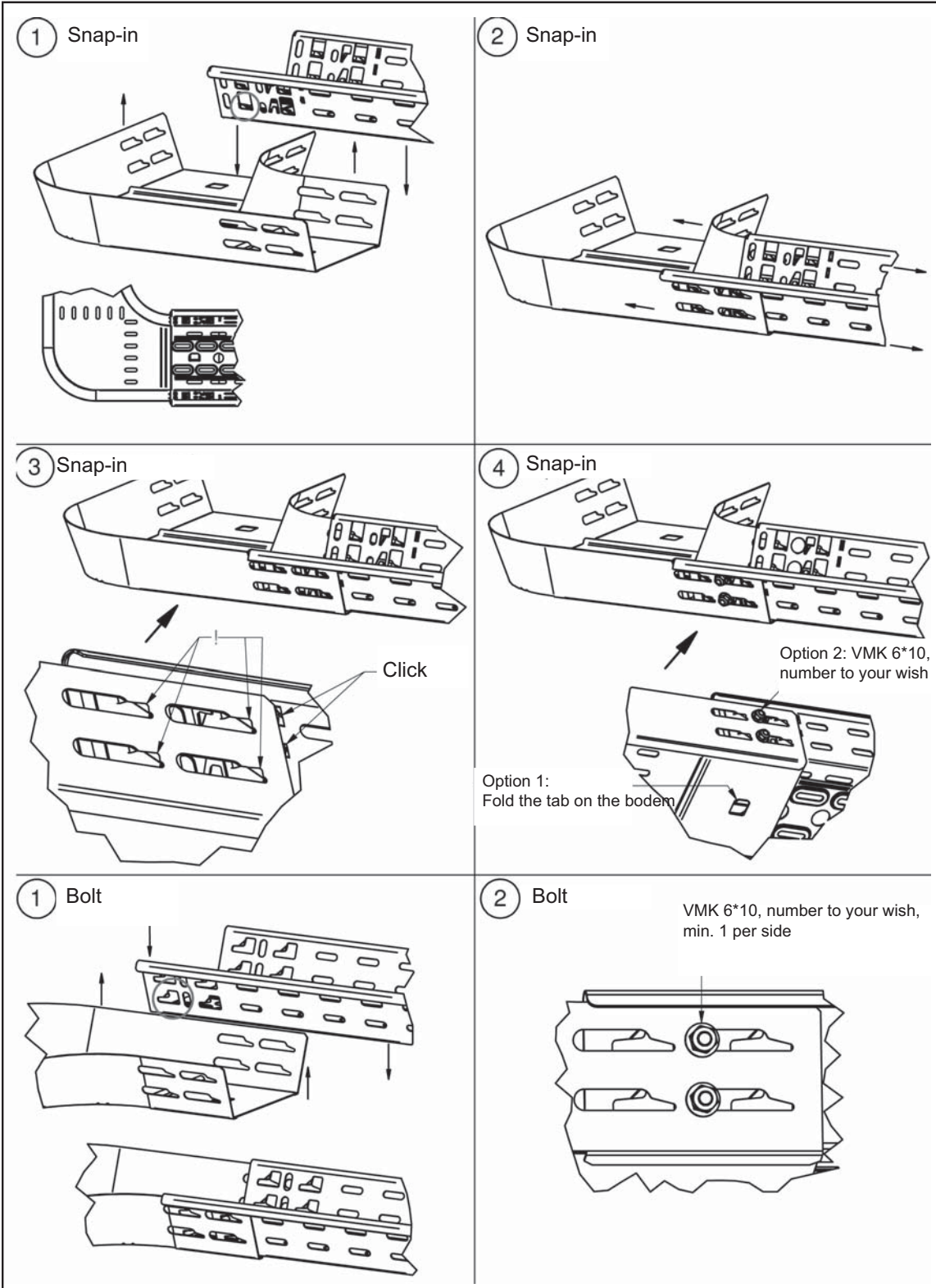

VHTI

Mounting principle

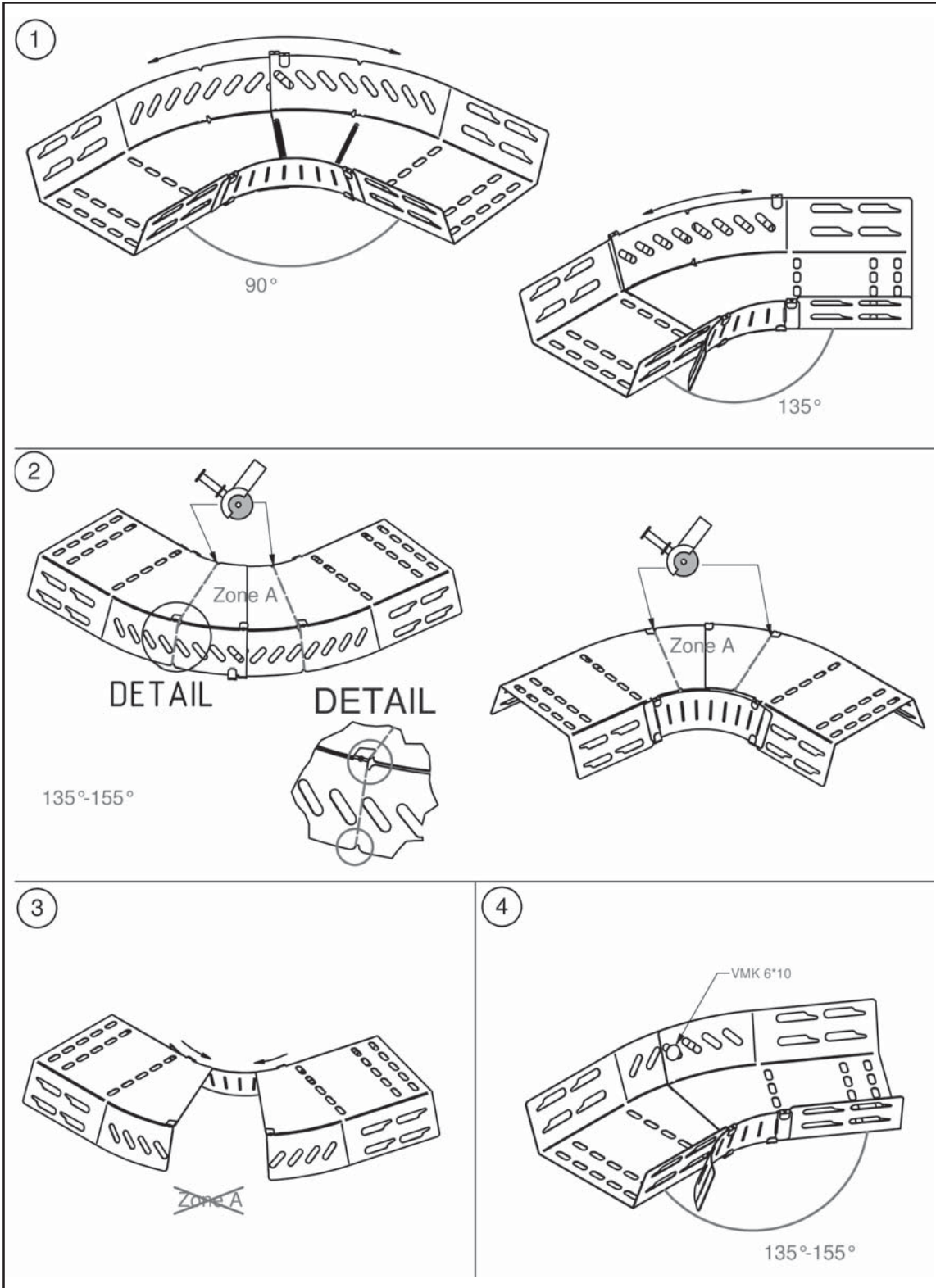

SDBTI

Mounting principle

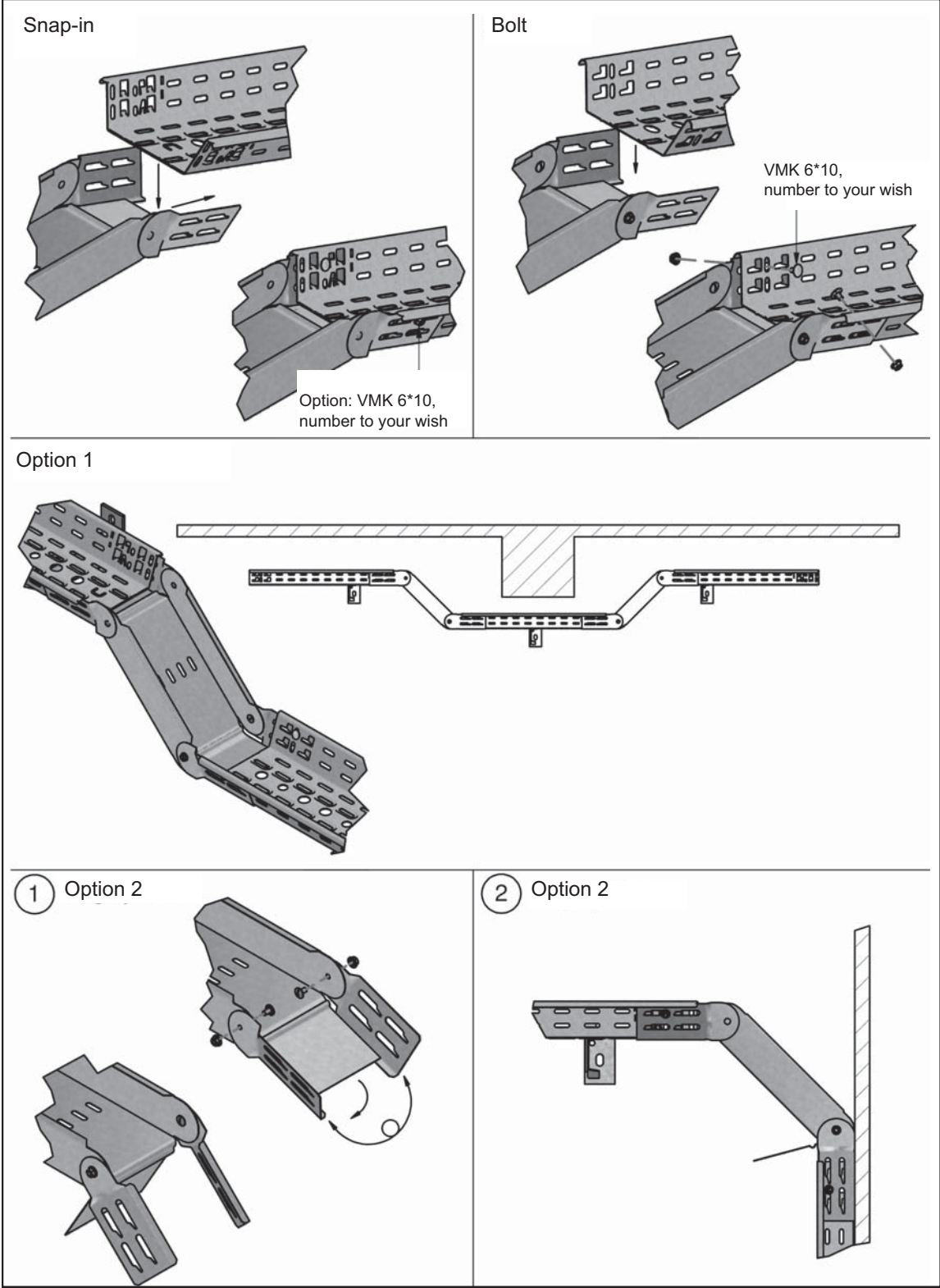

CABLE TRAYS

KBSI

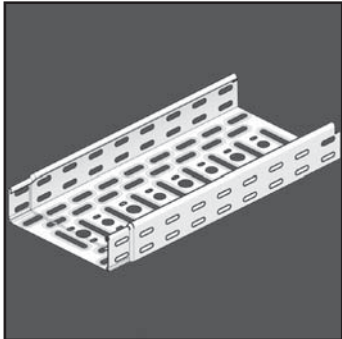

KBS

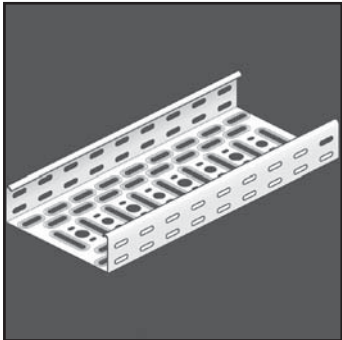

KGI / KG

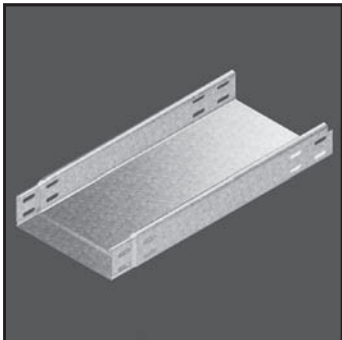

NATO

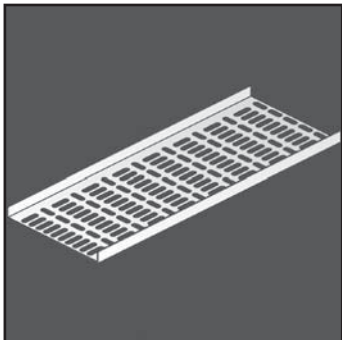

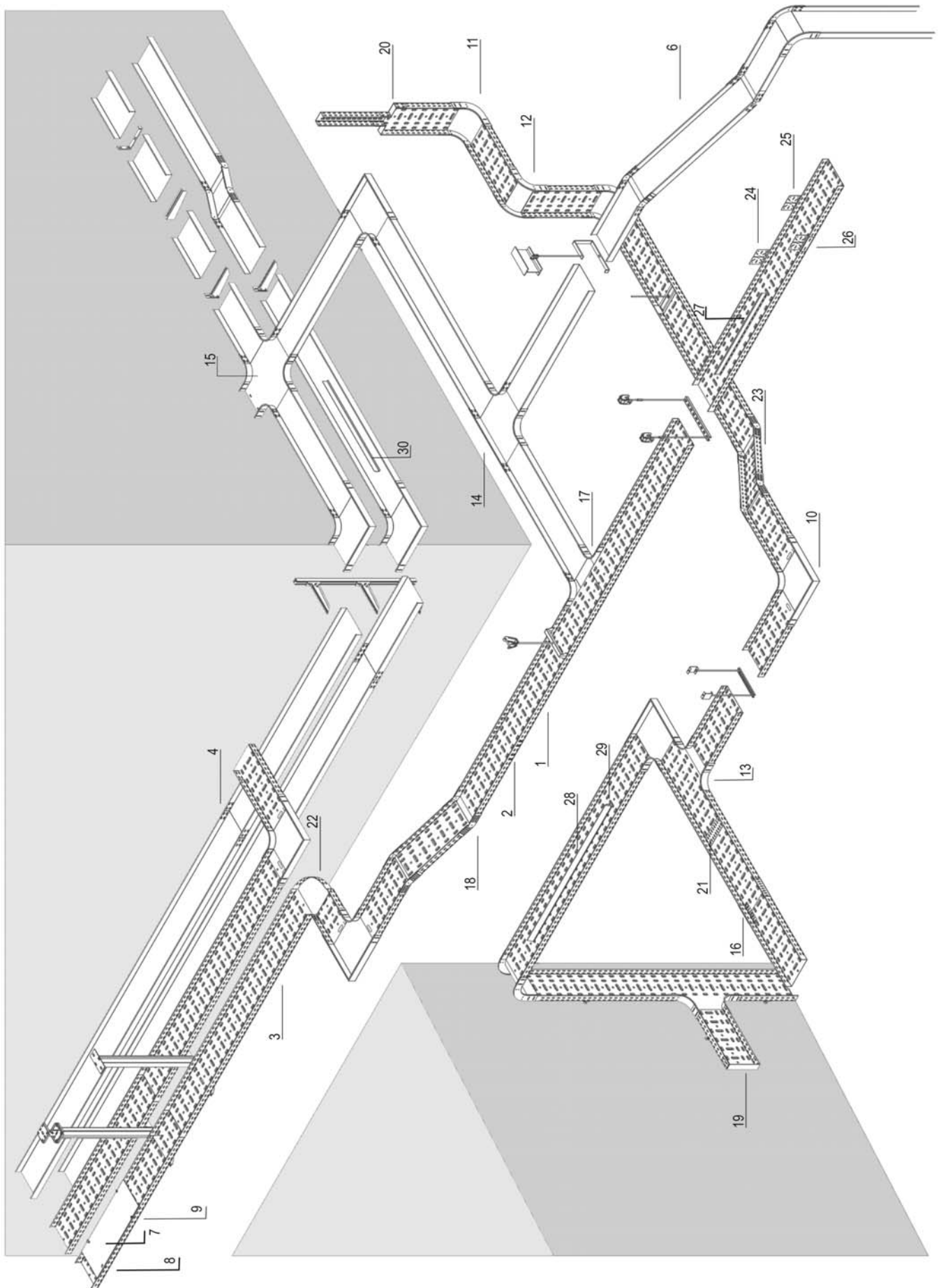

Survey of the system

	Description	Reference	Pag.
1	Cable tray with interlocking ends	KBSI 60	1-35
2	Fast locking for KBSI	KBV	1-71
3	Perforated cable tray	KBS 60	1-38
4	Jointing plate for fast mounting	V 60	1-68
6	Cable tray not perforated, interlocking	KGI 60	1-42
7	Universal cover	D	1-45
8	Lid clamp clips	DCL	1-46
9	Lid clamp	DCO	1-46
10	Horizontal bend 90°	B 90	1-47
11	Rising elbow 90°	SB 90	1-56
12	Low elbow 90°	VB 90	1-58
13	Horizontal adapter 90°	AS	1-52
14	Horizontal T-piece	T	1-50
15	Cross-over	KR	1-54
16	Supporting corner	LV	1-71
17	Universal coupling 90°	AZH	1-61
18	Hinged joint	DS	1-60
19	End piece	E	1-63
20	Reducing plate	VS	1-62
21	Stiffening plate	BVSI	1-61
22	Adjustable Corner 90-180°	VH	1-49
23	Hinged joint double	SDB	1-60
24	Flat mounting plate	MPV	1-64
25	Mounting plate clips	MPVCL	1-65
26	Folded mounting plate	MP	1-64
27	Division plate free	SLOS	1-66
28	Clip-in partition	SLIS	1-66
29	Clips for clip-in partition	CL	1-67
30	Build-in division plate	SIN	1-67

KBSI 35

Cable tray with interlocking ends



Interlocking ends
Alternative perforations
Return flanges

On Demand	Powder coating / Duplex System
Length	3000 mm
Standard finish	Pre-galvanised

1		Reference	Height	Width	Thickness	Length	kg/m	Packaging	Stock	Unit			
-	-	KBSI 35*075*0.75	35	75	0,75	3000	0,810	60	✓	m			
-	-	KBSI 35*075*1.00	35	75	1,00	3000	1,080	60	✓	m			
-	-	KBSI 35*100*0.75	35	100	0,75	3000	0,930	60	✓	m			
-	-	KBSI 35*100*1.00	35	100	1,00	3000	1,240	60	✓	m			
-	-	KBSI 35*150*0.75	35	150	0,75	3000	1,170	60	✓	m			
-	-	KBSI 35*150*1.00	35	150	1,00	3000	1,560	60	✓	m			
-	-	KBSI 35*200*0.75	35	200	0,75	3000	1,420	60	✓	m			
-	-	KBSI 35*200*1.00	35	200	1,00	3000	1,890	60	✓	m			
-	-	KBSI 35*300*0.75	35	300	0,75	3000	1,910	60	✓	m			
-	-	KBSI 35*300*1.00	35	300	1,00	3000	2,540	60	✓	m			

To fix with:													
-	-	KBV	-	-	-	-	0,010	96	✓	piece			

More technical specifications for this product can be found at the end of this chapter.

CHARACTERISTICS

The KBSI-cable tray returns a 30% mounting time advantage, compared to a traditional system with the use of jointing plates.

Embedded perforations for :

- extra load capacity
- better aeration
- better stability
- better condensation drainage

Alternative perforations for :

- better fixation on the supports
- very useful for cable fixation.

Earthing.

TECHNICAL INFORMATION

The perforation scheme differs according to the width.

The surface of the interlocking end is rounded in order to protect the cables.

Provide for an opening for the fitting of a gland, a round hole with

- Ø 16 mm for PG 11
- Ø 19,5 mm for PG 13,5

KBSI 60

Cable tray with interlocking ends

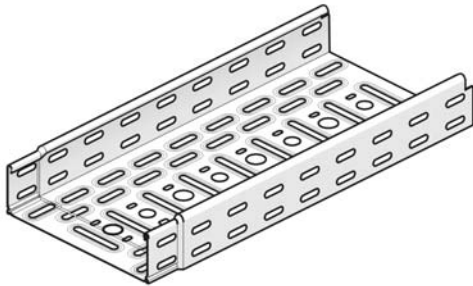

Interlocking ends
Alternative perforations
Return flanges

On Demand	Powder coating / Duplex System
Length	3000 mm
Standard finish	Pre-galvanised
Optional finish 1	Hot-dip galvanised

1		Reference	Height	Width	Thickness	Length	kg/m	Packaging	Stock	Unit			
HD	-	KBSI 60*075*0.75	60	75	0,75	3000	1,050	60	✓	m			
-	-	KBSI 60*075*1.00	60	75	1,00	3000	1,400	60	✓	m			
-	-	KBSI 60*075*1.25	60	75	1,25	3000	1,750	60	✓	m			
HD	-	KBSI 60*100*0.75	60	100	0,75	3000	1,170	60	✓	m			
HD	-	KBSI 60*100*1.00	60	100	1,00	3000	1,560	60	✓	m			
-	-	KBSI 60*100*1.25	60	100	1,25	3000	1,950	60	✓	m			
HD	-	KBSI 60*150*0.75	60	150	0,75	3000	1,420	30	✓	m			
HD	-	KBSI 60*150*1.00	60	150	1,00	3000	1,890	30	✓	m			
-	-	KBSI 60*150*1.25	60	150	1,25	3000	2,360	30	✓	m			
HD	-	KBSI 60*200*0.75	60	200	0,75	3000	1,660	30	✓	m			
HD	-	KBSI 60*200*1.00	60	200	1,00	3000	2,220	30	✓	m			
-	-	KBSI 60*200*1.25	60	200	1,25	3000	2,770	30	✓	m			
HD	-	KBSI 60*250*0.75	60	250	0,75	3000	1,910	30	✓	m			
-	-	KBSI 60*250*1.00	60	250	1,00	3000	2,540	30	✓	m			
HD	-	KBSI 60*300*0.75	60	300	0,75	3000	2,150	30	✓	m			
HD	-	KBSI 60*300*1.00	60	300	1,00	3000	2,870	30	✓	m			
-	-	KBSI 60*300*1.25	60	300	1,25	3000	3,580	30	✓	m			
HD	-	KBSI 60*400*1.00	60	400	1,00	3000	3,520	30	✓	m			
-	-	KBSI 60*400*1.25	60	400	1,25	3000	4,400	30	✓	m			
HD	-	KBSI 60*500*1.00	60	500	1,00	3000	4,170	30	✓	m			
-	-	KBSI 60*500*1.25	60	500	1,25	3000	5,210	30	✓	m			
-	-	KBSI 60*600*1.00	60	600	1,00	3000	4,820	30	✓	m			
-	-	KBSI 60*600*1.25	60	600	1,25	3000	6,030	30	✓	m			

To fix with:

-	-	KBV	-	-	-	-	0,010	96	✓	piece			
---	---	-----	---	---	---	---	-------	----	---	-------	--	--	--

More technical specifications for this product can be found at the end of this chapter.

Other lengths min. 1.80m / max. 6m for each run of 100mm.

KBSI 60*6

Cable tray with interlocking ends

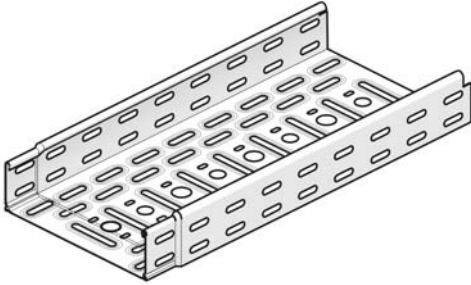

Interlocking ends
Alternative perforations
Return flanges

On Demand	Powder coating / Duplex System
Length	6000 mm
Standard finish	Pre-galvanised

1		Reference	Height	Width	Thickness	Length	kg/m	Packaging	Stock	Unit			
-	-	KBSI 60*075*1.00*6	60	75	1,00	6000	1,400	60	✓	m			
-	-	KBSI 60*100*1.00*6	60	100	1,00	6000	1,560	60	✓	m			
-	-	KBSI 60*150*1.00*6	60	150	1,00	6000	1,890	30	✓	m			
-	-	KBSI 60*200*1.00*6	60	200	1,00	6000	2,220	30	✓	m			
-	-	KBSI 60*300*1.00*6	60	300	1,00	6000	2,870	30	✓	m			
-	-	KBSI 60*400*1.00*6	60	400	1,00	6000	3,520	30	✓	m			

To fix with:

-	-	KBV	-	-	-	-	0,010	96	✓	piece			
---	---	-----	---	---	---	---	-------	----	---	-------	--	--	--

More technical specifications for this product can be found at the end of this chapter.

Other lengths on request : min. 1,80 m / max. 6 m per steps of 100 mm.

CHARACTERISTICS

The KBSI-cable tray returns a 30% mounting time advantage, compared to a traditional system with the use of jointing plates.

Embedded perforations for :

- extra load capacity
- better aeration
- better stability
- better condensation drainage

Alternative perforations for :

- better fixation on the supports
- very useful for cable fixation.

Earthing.

TECHNICAL INFORMATION

The perforation scheme differs according to the width. Alternative perforation beginning at width 200 mm.

The surface of the interlocking end is rounded in order to protect the cables.

Provide for an opening for the fitting of a gland, a round hole with

Ø 16 mm for PG 11

Ø 19,5 mm for PG 13,5

Separation 'SLIS 60' can be used on any width from 200 mm.

KBS 35

Perforated cable tray

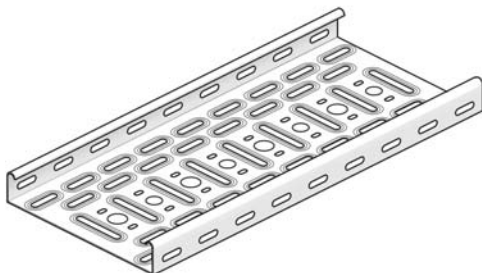

Alternative perforation
Return flanges

On Demand	Powder coating / Duplex System
Length	3000 mm
Standard finish	Pre-galvanised
Optional finish 1	Hot-dip galvanised

1	Reference	Height	Width	Thickness	Length	kg/m	Packaging	Stock	Unit			
HD	- KBS 35*050*0.75	35	50	0,75	3000	0,680	150	✓	m			
HD	- KBS 35*050*1.00	35	50	1,00	3000	0,912	150	✓	m			
HD	- KBS 35*075*0.75	35	75	0,75	3000	0,810	60	✓	m			
HD	- KBS 35*075*1.00	35	75	1,00	3000	1,080	60	✓	m			
HD	- KBS 35*100*0.75	35	100	0,75	3000	0,930	60	✓	m			
HD	- KBS 35*100*1.00	35	100	1,00	3000	1,240	60	✓	m			
HD	- KBS 35*150*0.75	35	150	0,75	3000	1,170	60	✓	m			
HD	- KBS 35*150*1.00	35	150	1,00	3000	1,560	60	✓	m			
HD	- KBS 35*200*0.75	35	200	0,75	3000	1,420	60	✓	m			
HD	- KBS 35*200*1.00	35	200	1,00	3000	1,890	60	✓	m			
HD	- KBS 35*300*0.75	35	300	0,75	3000	1,910	60	✓	m			
HD	- KBS 35*300*1.00	35	300	1,00	3000	2,540	60	✓	m			
HD	- KBS 35*400*1.00	35	400	1,00	3000	3,190	60	✓	m			
HD	- KBS 35*500*1.00	35	500	1,00	3000	3,840	60	✓	m			
HD	- KBS 35*600*1.00	35	600	1,00	3000	4,500	60	✓	m			

To fix with:

-	- V 35	35	-	-	-	0,050	48	✓	piece			
HD	- V 35*200	35	200	-	-	0,040	48	✓	piece			

More technical specifications for this product can be found at the end of this chapter.

CHARACTERISTICS

Embedded perforations for :

- extra load capacity
- better aeration
- better stability
- better condensation drainage

Alternative perforations for :

- better fixation on the supports
- very useful for cable fixation

TECHNICAL INFORMATION

The perforation scheme differs according to the width. Alternative perforation beginning at 200 mm.

Provide for an opening for the fitting of a gland, a round hole with

- Ø 16 mm for PG 11
- Ø 19,5 mm for PG 13,5

KBS 35*050*0.75 en KBS 35*050*1.00: no knock-out facility (pre-shaped holes)

KBS 60

Perforated cable tray

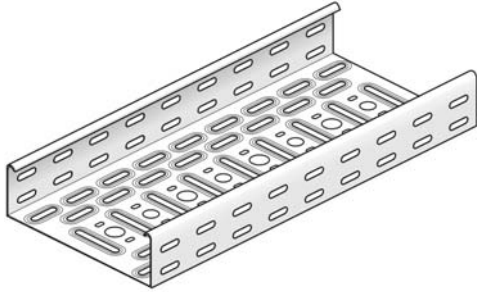

Alternative perforation
Return flanges

On Demand	Powder coating / Duplex System
Length	3000 mm
Standard finish	Pre-galvanised
Optional finish 1	Hot-dip galvanised

1		Reference	Height	Width	Thickness	Length	kg/m	Packaging	Stock	Unit			
HD	-	KBS 60*050*0.75	60	50	0,75	3000	0,930	60	✓	m			
HD	-	KBS 60*050*1.00	60	50	1,00	3000	1,240	60	✓	m			
HD	-	KBS 60*075*1.00	60	75	1,00	3000	1,400	60	✓	m			
HD	-	KBS 60*075*1.25	60	75	1,25	3000	1,750	60	✓	m			
HD	-	KBS 60*100*1.00	60	100	1,00	3000	1,560	60	✓	m			
HD	-	KBS 60*100*1.25	60	100	1,25	3000	1,950	60	✓	m			
HD	-	KBS 60*100*1.50	60	100	1,50	3000	2,350	60	✓	m			
HD	-	KBS 60*150*1.00	60	150	1,00	3000	1,890	30	✓	m			
HD	-	KBS 60*150*1.25	60	150	1,25	3000	2,360	30	✓	m			
HD	-	KBS 60*150*1.50	60	150	1,50	3000	2,830	30	✓	m			
HD	-	KBS 60*200*1.00	60	200	1,00	3000	2,220	30	✓	m			
HD	-	KBS 60*200*1.25	60	200	1,25	3000	2,770	30	✓	m			
HD	-	KBS 60*200*1.50	60	200	1,50	3000	3,320	30	✓	m			
HD	-	KBS 60*250*1.00	60	250	1,00	3000	2,540	30	✓	m			
HD	-	KBS 60*300*1.00	60	300	1,00	3000	2,870	30	✓	m			
HD	-	KBS 60*300*1.25	60	300	1,25	3000	3,580	30	✓	m			
HD	-	KBS 60*300*1.50	60	300	1,50	3000	4,300	30	✓	m			
HD	-	KBS 60*400*1.00	60	400	1,00	3000	3,520	30	✓	m			
HD	-	KBS 60*400*1.25	60	400	1,25	3000	4,400	30	✓	m			
HD	-	KBS 60*400*1.50	60	400	1,50	3000	5,280	30	✓	m			
HD	-	KBS 60*500*1.00	60	500	1,00	3000	4,170	30	✓	m			
HD	-	KBS 60*500*1.25	60	500	1,25	3000	5,210	30	✓	m			
HD	-	KBS 60*500*1.50	60	500	1,50	3000	6,250	30	✓	m			
HD	-	KBS 60*600*1.25	60	600	1,25	3000	6,030	30	✓	m			
HD	-	KBS 60*600*1.50	60	600	1,50	3000	7,230	30	✓	m			

To fix with:

-	-	V 60	60	-	-	-	0,090	48	✓	piece			
HD	-	V 60*200	60	200	-	-	0,080	48	✓	piece			

More technical specifications for this product can be found at the end of this chapter.

Provide for an opening for the fitting of a gland, a round hole with:

- Ø 16 mm for PG 11
- Ø 19,5 mm for PG 13,5.

KBS 60*050*0.75 and KBS 60*050*1.00: No knock-out facility (pre-shaped holes)

KBS 85

Perforated cable tray

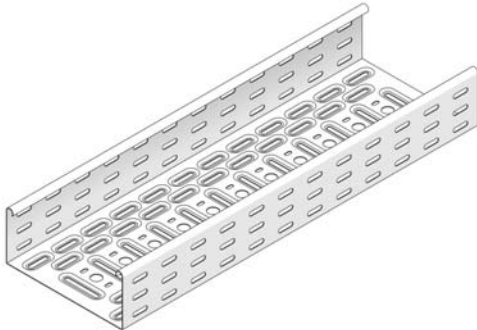

Alternative perforation
Return flanges

On Demand	Powder coating / Duplex System
Length	3000 mm
Standard finish	Pre-galvanised
Optional finish 1	Hot-dip galvanised

1		Reference	Height	Width	Thickness	Length	kg/m	Packaging	Stock	Unit			
HD	-	KBS 85*100*1.00	85	100	1,00	3000	1,890	24	✓	m			
HD	-	KBS 85*150*1.00	85	150	1,00	3000	2,220	24	✓	m			
HD	-	KBS 85*200*1.00	85	200	1,00	3000	2,540	24	✓	m			
HD	-	KBS 85*300*1.00	85	300	1,00	3000	3,190	24	✓	m			
HD	-	KBS 85*400*1.00	85	400	1,00	3000	3,840	24	✓	m			
HD	-	KBS 85*400*1.50	85	400	1,50	3000	5,770	24	✓	m			
HD	-	KBS 85*500*1.25	85	500	1,25	3000	5,620	24	✓	m			
HD	-	KBS 85*500*1.50	85	500	1,50	3000	6,740	24	✓	m			
HD	-	KBS 85*600*1.25	85	600	1,25	3000	6,430	24	✓	m			
HD	-	KBS 85*600*1.50	85	600	1,50	3000	7,720	24	✓	m			

To fix with:

-	-	V 85	85	-	-	-	0,130	48	✓	piece			
HD	-	V 85*200	85	200	-	-	0,130	48	✓	piece			

More technical specifications for this product can be found at the end of this chapter.

CHARACTERISTICS

Embedded perforations for :

- extra load capacity
- better aeration
- better stability
- better condensation drainage

Alternative perforations for :

- better fixation on the supports
- very useful for cable fixation

TECHNICAL INFORMATION

The perforation scheme differs according to the width. Alternative perforation beginning at 200 mm.

Provide for an opening for the fitting of a gland, a round hole with

- Ø 16 mm for PG 11
- Ø 19,5 mm for PG 13,5

KBS 110

Perforated cable tray

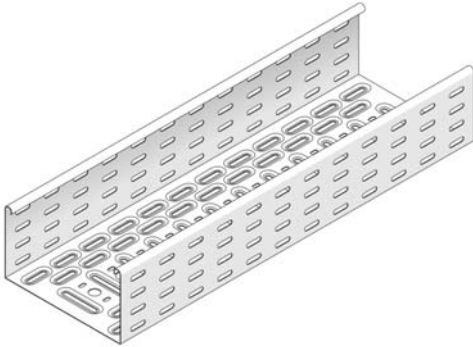

Alternative perforation
Return flanges

On Demand	Powder coating / Duplex System
Length	3000 mm
Standard finish	Pre-galvanised
Optional finish 1	Hot-dip galvanised

1		Reference	Height	Width	Thickness	Length	kg/m	Packaging	Stock	Unit			
HD	-	KBS 110*150*1.25	110	150	1,25	3000	3,180	24	✓	m			
HD	-	KBS 110*200*1.25	110	200	1,25	3000	3,580	24	✓	m			
HD	-	KBS 110*300*1.25	110	300	1,25	3000	4,400	24	✓	m			
HD	-	KBS 110*400*1.25	110	400	1,25	3000	5,210	24	✓	m			
HD	-	KBS 110*500*1.25	110	500	1,25	3000	6,030	24	✓	m			
HD	-	KBS 110*500*1.50	110	500	1,50	3000	7,230	24	✓	m			
HD	-	KBS 110*600*1.25	110	600	1,25	3000	6,840	24	✓	m			
HD	-	KBS 110*600*1.50	110	600	1,50	3000	8,210	24	✓	m			

To fix with:

HD	-	V 110*200	110	200	-	-	0,170	48	✓	piece			
----	---	-----------	-----	-----	---	---	-------	----	---	-------	--	--	--

More technical specifications for this product can be found at the end of this chapter.

CHARACTERISTICS

Embedded perforations for :

- extra load capacity
- better aeration
- better stability
- better condensation drainage

Alternative perforations for :

- better fixation on the supports
- very useful for cable fixation

TECHNICAL INFORMATION

The perforation scheme differs according to the width. Alternative perforation beginning at 200 mm.

Provide for an opening for the fitting of a gland, a round hole with

- Ø 16 mm for PG 11
- Ø 19,5 mm for PG 13,5

KBS 110*6

Perforated cable tray

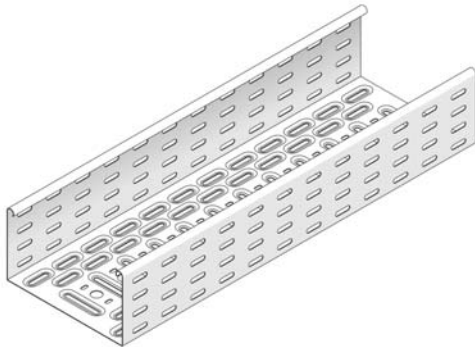

Alternative perforation
Return flanges
Support distance up to 6 meter

On Demand	Powder coating / Duplex System
Length	6000 mm
Standard finish	Pre-galvanised
Optional finish 1	Hot-dip galvanised

1		Reference	Height	Width	Thickness	Length	kg/m	Packaging	Stock	Unit			
HD	-	KBS 110*200*1.50*6	110	200	1,50	6000	4,300	24	✓	m			
HD	-	KBS 110*300*1.50*6	110	300	1,50	6000	5,280	24	✓	m			
HD	-	KBS 110*400*1.50*6	110	400	1,50	6000	6,250	24	✓	m			
HD	-	KBS 110*500*1.50*6	110	500	1,50	6000	7,230	24	✓	m			
HD	-	KBS 110*600*1.50*6	110	600	1,50	6000	8,210	24	✓	m			

To fix with:

HD	-	KPW	110	-	-	-	0,590	24	✓	piece			
----	---	-----	-----	---	---	---	-------	----	---	-------	--	--	--

More technical specifications for this product can be found at the end of this chapter.

CHARACTERISTICS

Embedded perforations for :

- extra load capacity
- better aeration
- better stability
- better condensation drainage

Alternative perforations for :

- better fixation on the supports
- very useful for cable fixation

TECHNICAL INFORMATION

The perforation scheme differs according to the width. Alternative perforation beginning at 200 mm.

Provide for an opening for the fitting of a gland, a round hole with

- Ø 16 mm for PG 11
- Ø 19,5 mm for PG 13,5

KGI 60

Cable tray not perforated, interlocking



Not perforated
Return flanges

On Demand	Height 35 mm
On Demand	Powder coating / Duplex System
Length	3000 mm
Standard finish	Pre-galvanised
Optional finish 1	Hot-dip galvanised

1		Reference	Height	Width	Thickness	Length	kg/m	Packaging	Stock	Unit			
HD	-	KGI 60*075*1.00	60	75	1,00	3000	1,700	3	✓	m			
HD	-	KGI 60*100*1.00	60	100	1,00	3000	1,900	3	✓	m			
HD	-	KGI 60*150*1.00	60	150	1,00	3000	2,300	3	✓	m			
HD	-	KGI 60*200*1.00	60	200	1,00	3000	2,700	3	✓	m			
HD	-	KGI 60*250*1.00	60	250	1,00	3000	3,100	3	✓	m			
HD	-	KGI 60*300*1.00	60	300	1,00	3000	3,500	3	✓	m			
-	-	KGI 60*300*1.25	60	300	1,25	3000	4,300	3	✓	m			
HD	-	KGI 60*400*1.00	60	400	1,00	3000	4,300	3	✓	m			
-	-	KGI 60*400*1.25	60	400	1,25	3000	5,300	3	✓	m			
-	-	KGI 60*500*1.25	60	500	1,25	3000	6,300	3	✓	m			
-	-	KGI 60*600*1.25	60	600	1,25	3000	7,300	3	✓	m			

To fix with:

-	-	KBV	-	-	-	-	0,010	96	✓	piece			
---	---	-----	---	---	---	---	-------	----	---	-------	--	--	--

More technical specifications for this product can be found at the end of this chapter.

KG 110

Cable tray not perforated

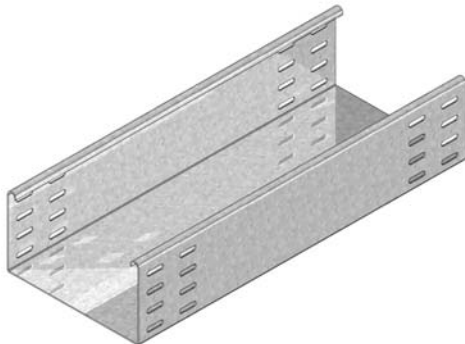

Not perforated
Return flanges

On Demand	Height 85 mm
On Demand	Powder coating / Duplex System
Length	3000 mm
Standard finish	Pre-galvanised
Optional finish 1	Hot-dip galvanised

1		Reference	Height	Width	Thickness	Length	kg/m	Packaging	Stock	Unit			
HD	-	KG 110*100*1.50	110	100	1,50	3000	4,000	18	✓	m			
HD	-	KG 110*150*1.50	110	150	1,50	3000	4,590	18	✓	m			
HD	-	KG 110*200*1.50	110	200	1,50	3000	5,180	18	✓	m			
HD	-	KG 110*300*1.50	110	300	1,50	3000	6,360	18	✓	m			
HD	-	KG 110*400*1.50	110	400	1,50	3000	7,540	18	✓	m			
HD	-	KG 110*500*1.50	110	500	1,50	3000	8,710	18	✓	m			
HD	-	KG 110*600*1.50	110	600	1,50	3000	9,890	18	✓	m			

To fix with:

1		Reference	Height	Width	Thickness	Length	kg/m	Packaging	Stock	Unit			
HD	-	V 110*200	110	200	-	-	0,170	48	✓	piece			

More technical specifications for this product can be found at the end of this chapter.

NATO 15

Perforated cable tray - upright flanges

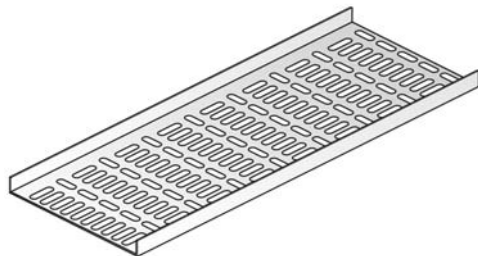

Linear and alternative perforations
Upright flanges

On Demand	Powder coating / Duplex System
Length	2000 mm
Standard finish	Pre-galvanised
Optional finish 1	Hot-dip galvanised

1		Reference	Height	Width	Thickness	Length	kg/m	Packaging	Stock	Unit			
HD	-	NATO 15*050*1.25	15	50	1,25	2000	0,730	40	✓	m			
HD	-	NATO 15*100*1.25	15	100	1,25	2000	1,050	20	✓	m			
HD	-	NATO 15*150*1.25	15	150	1,25	2000	1,350	20	✓	m			
HD	-	NATO 15*200*1.25	15	200	1,25	2000	1,700	20	✓	m			
HD	-	NATO 15*300*1.25	15	300	1,25	2000	2,400	20	✓	m			

To fix with:

HD	-	V 15*200	15	200	-	-	0,050	48	✓	piece			
----	---	----------	----	-----	---	---	-------	----	---	-------	--	--	--

More technical specifications for this product can be found at the end of this chapter.

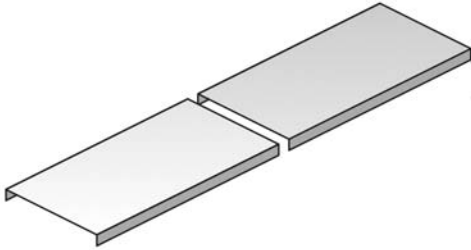
D
Universal cover

Especially used for horizontal en vertical sections.
Cover with board height 10 mm.

On Demand	Powder coating / Duplex System
Standard finish	Pre-galvanised
Optional finish 1	Hot-dip galvanised

1		Reference	Height	Width	Thickness	Length	kg/m	Packaging	Stock	Unit			
HD	-	D 050	-	50	-	3000	0,350	3	✓	m			
HD	-	D 075	-	75	-	2000	0,500	10	✓	m			
HD	-	D 100	-	100	-	2000	0,820	10	✓	m			
HD	-	D 150	-	150	-	2000	1,170	10	✓	m			
HD	-	D 200	-	200	-	2000	1,420	10	✓	m			
HD	-	D 250	-	250	-	2000	1,850	10	✓	m			
HD	-	D 300	-	300	-	2000	2,100	10	✓	m			
HD	-	D 400	-	400	-	2000	4,150	10	✓	m			
HD	-	D 500	-	500	-	2000	5,000	10	✓	m			
HD	-	D 600	-	600	-	2000	5,650	10	✓	m			

To fix with:

-	-	DCO	-	-	-	-	0,010	96	✓	piece			
-	-	DCL	-	-	-	-	0,005	96	✓	piece			

Covers with width > 400 mm are delivered with diagonal reinforcements.

DCO

Lid clamp

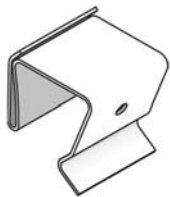

		Standard finish						Spring steel					
1		Reference	Height	Width	Thickness	Length	kg/piece	Packaging	Stock	Unit			
-	-	DCO	-	-	-	-	0,010	96	✓	piece			

2 pieces per meter.

DCL

Lid clamp clips



		Standard finish						Stainless Steel					
1		Reference	Height	Width	Thickness	Length	kg/piece	Packaging	Stock	Unit			
-	-	DCL	-	-	-	-	0,005	96	✓	piece			

2 pieces per meter.
Not applicable for KG.

B 90

Horizontal bend 90°

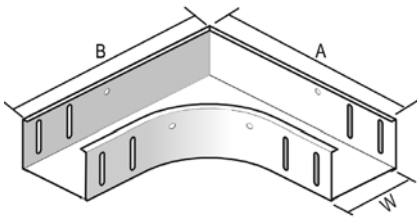

Slides over the cable trays

W	50	75	100	150	200	250	300	400	500	600
A	255	280	305	355	405	455	505	605	705	805
B	255	280	305	355	405	455	505	605	705	805

Radius	100 mm
On Demand	Height 35mm - 85mm - 110mm
On Demand	Powder coating / Duplex System
Standard finish	Pre-galvanised
Optional finish 1	Hot-dip galvanised

1		Reference	Height	Width	Thickness	Length	kg/piece	Packaging	Stock	Unit			
HD	-	B 90*60*050	60	50	-	-	0,474	1	✓	piece			
HD	-	B 90*60*075	60	75	-	-	0,516	1	✓	piece			
HD	-	B 90*60*100	60	100	-	-	0,738	1	✓	piece			
HD	-	B 90*60*150	60	150	-	-	0,822	1	✓	piece			
HD	-	B 90*60*200	60	200	-	-	1,374	1	✓	piece			
HD	-	B 90*60*250	60	250	-	-	1,858	1	✓	piece			
HD	-	B 90*60*300	60	300	-	-	2,292	1	✓	piece			
HD	-	B 90*60*400	60	400	-	-	2,958	1	✓	piece			
HD	-	B 90*60*500	60	500	-	-	5,424	1	✓	piece			
HD	-	B 90*60*600	60	600	-	-	6,690	1	✓	piece			

To fix with:

HD	-	VM 6*10	-	-	M6	10	0,010	250	✓	piece			
HD	-	VMK 6*10	-	-	M6	-	0,010	250	✓	piece			

More technical specifications for this product can be found at the end of this chapter.

Minimum number bolts and nuts VM 6*10: 8 pieces.

DB 90

Cover for horizontal bend 90°

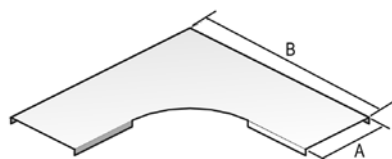

	50	75	100	150	200	250	300	400	500	600
A	56	81	106	156	206	256	306	406	506	606
B	256	281	306	356	406	456	506	606	706	806

On Demand	Powder coating / Duplex System
Standard finish	Pre-galvanised
Optional finish 1	Hot-dip galvanised

1		Reference	Height	Width	Thickness	Length	kg/piece	Packaging	Stock	Unit			
HD	-	DB 90*050	-	50	-	-	0,250	1	✓	piece			
HD	-	DB 90*075	-	75	-	-	0,300	1	✓	piece			
HD	-	DB 90*100	-	100	-	-	0,440	1	✓	piece			
HD	-	DB 90*150	-	150	-	-	0,720	1	✓	piece			
HD	-	DB 90*200	-	200	-	-	0,950	1	✓	piece			
HD	-	DB 90*250	-	250	-	-	1,250	1	✓	piece			
HD	-	DB 90*300	-	300	-	-	1,920	1	✓	piece			
HD	-	DB 90*400	-	400	-	-	2,400	1	✓	piece			
HD	-	DB 90*500	-	500	-	-	3,540	1	✓	piece			
HD	-	DB 90*600	-	600	-	-	6,130	1	✓	piece			

To fix with:

-	-	DCL	-	-	-	-	0,005	96	✓	piece			
---	---	-----	---	---	---	---	-------	----	---	-------	--	--	--

Accessories

VH

Adjustable Corner 90-180°

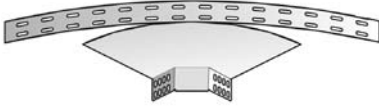

Corner plate adjustable between 90° and 180°

On Demand	Height 35 mm - 85 mm - 110 mm
On Demand	Powder coating / Duplex System
Standard finish	Pre-galvanised
Optional finish 1	Hot-dip galvanised

1		Reference	Height	Width	Thickness	Length	kg/piece	Packaging	Stock	Unit			
HD	-	VH 60*050	60	50	-	-	0,350	1	✓	piece			
HD	-	VH 60*075	60	75	-	-	0,350	1	✓	piece			
HD	-	VH 60*100	60	100	-	-	0,400	1	✓	piece			
HD	-	VH 60*150	60	150	-	-	0,500	1	✓	piece			
HD	-	VH 60*200	60	200	-	-	0,700	1	✓	piece			
HD	-	VH 60*250	60	250	-	-	0,900	1	✓	piece			
HD	-	VH 60*300	60	300	-	-	1,150	1	✓	piece			
HD	-	VH 60*400	60	400	-	-	1,700	1	✓	piece			
HD	-	VH 60*500	60	500	-	-	2,500	1	✓	piece			
HD	-	VH 60*600	60	600	-	-	3,450	1	✓	piece			
To fix with:													
HD	-	VM 6*10	-	-	M6	10	0,010	250	✓	piece			
HD	-	VMK 6*10	-	-	M6	-	0,010	250	✓	piece			

Minimum number bolts and nuts VM 6*10: 4 pieces.

T

Horizontal T-piece

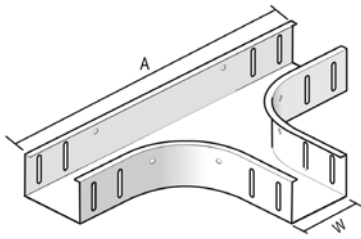

Slides over the cable trays

W	50	75	100	150	200	250	300	400	500	600
A	458	483	508	558	608	658	708	808	908	1008

Radius	100 mm
On Demand	Height 35 mm - 85 mm - 110 mm
On Demand	Powder coating / Duplex System
Standard finish	Pre-galvanised
Optional finish 1	Hot-dip galvanised

1		Reference	Height	Width	Thickness	Length	kg/piece	Packaging	Stock	Unit			
HD	-	T 60*050	60	50	-	-	0,832	1	✓	piece			
HD	-	T 60*075	60	75	-	-	0,978	1	✓	piece			
HD	-	T 60*100	60	100	-	-	1,124	1	✓	piece			
HD	-	T 60*150	60	150	-	-	1,516	1	✓	piece			
HD	-	T 60*200	60	200	-	-	1,758	1	✓	piece			
HD	-	T 60*250	60	250	-	-	2,250	1	✓	piece			
HD	-	T 60*300	60	300	-	-	2,590	1	✓	piece			
HD	-	T 60*400	60	400	-	-	3,380	1	✓	piece			
HD	-	T 60*500	60	500	-	-	6,120	1	✓	piece			
HD	-	T 60*600	60	600	-	-	7,260	1	✓	piece			

To fix with:

HD	-	VM 6*10	-	-	M6	10	0,010	250	✓	piece			
HD	-	VMK 6*10	-	-	M6	-	0,010	250	✓	piece			

Minimum number bolts and nuts VM 6*10: 12 pieces.

Accessories

DT

Cover for horizontal T-piece

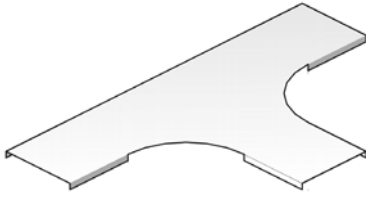

For all heights

On Demand	Powder coating / Duplex System
Standard finish	Pre-galvanised
Optional finish 1	Hot-dip galvanised

1		Reference	Height	Width	Thickness	Length	kg/piece	Packaging	Stock	Unit			
HD	-	DT 050	-	50	-	-	0,350	1	✓	piece			
HD	-	DT 075	-	75	-	-	0,480	1	✓	piece			
HD	-	DT 100	-	100	-	-	0,620	1	✓	piece			
HD	-	DT 150	-	150	-	-	0,910	1	✓	piece			
HD	-	DT 200	-	200	-	-	1,270	1	✓	piece			
HD	-	DT 250	-	250	-	-	1,780	1	✓	piece			
HD	-	DT 300	-	300	-	-	2,160	1	✓	piece			
HD	-	DT 400	-	400	-	-	2,950	1	✓	piece			
HD	-	DT 500	-	500	-	-	5,500	1	✓	piece			
HD	-	DT 600	-	600	-	-	7,200	1	✓	piece			

To fix with:

-	-	DCL	-	-	-	-	0,005	96	✓	piece			
---	---	-----	---	---	---	---	-------	----	---	-------	--	--	--

AS

Horizontal adapter 90°

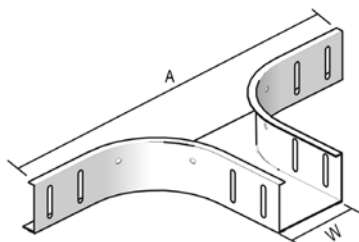

Slides over the cable trays

W	50	75	100	150	200	250	300	400	500	600
A	458	483	508	558	608	658	708	808	908	1008

Radius	100 mm
On Demand	Height 35 mm - 85 mm - 110 mm
On Demand	Powder coating / Duplex System
Standard finish	Pre-galvanised
Optional finish 1	Hot-dip galvanised

1	Reference	Height	Width	Thickness	Length	kg/piece	Packaging	Stock	Unit
HD	- AS 60*050	60	50	-	-	0,580	1	✓	piece
HD	- AS 60*075	60	75	-	-	0,620	1	✓	piece
HD	- AS 60*100	60	100	-	-	0,680	1	✓	piece
HD	- AS 60*150	60	150	-	-	0,710	1	✓	piece
HD	- AS 60*200	60	200	-	-	0,810	1	✓	piece
HD	- AS 60*250	60	250	-	-	0,910	1	✓	piece
HD	- AS 60*300	60	300	-	-	0,930	1	✓	piece
HD	- AS 60*400	60	400	-	-	1,130	1	✓	piece
HD	- AS 60*500	60	500	-	-	1,530	1	✓	piece
HD	- AS 60*600	60	600	-	-	1,780	1	✓	piece

To fix with:

HD	- VM 6*10	-	-	M6	10	0,010	250	✓	piece
HD	- VMK 6*10	-	-	M6	-	0,010	250	✓	piece

Minimum number bolts and nuts VM 6*10: 8 pieces.

Accessories

DAS

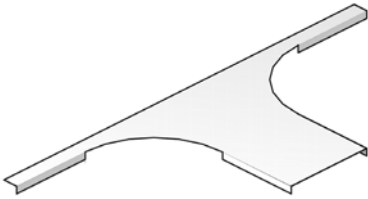
Cover for horizontal adapter 90°

For all heights

On Demand	Powder coating / Duplex System
Standard finish	Pre-galvanised
Optional finish 1	Hot-dip galvanised

1		Reference	Height	Width	Thickness	Length	kg/piece	Packaging	Stock	Unit			
HD	-	DAS 050	-	50	-	-	0,200	1	✓	piece			
HD	-	DAS 075	-	75	-	-	0,220	1	✓	piece			
HD	-	DAS 100	-	100	-	-	0,240	1	✓	piece			
HD	-	DAS 150	-	150	-	-	0,360	1	✓	piece			
HD	-	DAS 200	-	200	-	-	0,400	1	✓	piece			
HD	-	DAS 250	-	250	-	-	0,550	1	✓	piece			
HD	-	DAS 300	-	300	-	-	0,680	1	✓	piece			
HD	-	DAS 400	-	400	-	-	0,750	1	✓	piece			
HD	-	DAS 500	-	500	-	-	0,980	1	✓	piece			
HD	-	DAS 600	-	600	-	-	1,130	1	✓	piece			

To fix with:

-	-	DCL	-	-	-	-	0,005	96	✓	piece			
---	---	-----	---	---	---	---	-------	----	---	-------	--	--	--

KR

Cross-over

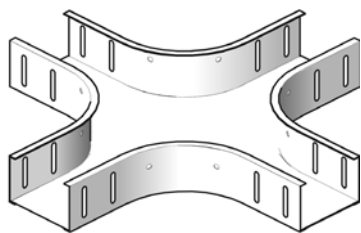

Slides over the cable trays

Radius	100 mm
On Demand	Height 35 mm - 85 mm - 110 mm
On Demand	Powder coating / Duplex System
Standard finish	Pre-galvanised
Optional finish 1	Hot-dip galvanised

1		Reference	Height	Width	Thickness	Length	kg/piece	Packaging	Stock	Unit			
HD	-	KR 60*050	60	50	-	-	1,180	1	✓	piece			
HD	-	KR 60*075	60	75	-	-	1,560	1	✓	piece			
HD	-	KR 60*100	60	100	-	-	1,480	1	✓	piece			
HD	-	KR 60*150	60	150	-	-	2,080	1	✓	piece			
HD	-	KR 60*200	60	200	-	-	2,380	1	✓	piece			
HD	-	KR 60*250	60	250	-	-	2,760	1	✓	piece			
HD	-	KR 60*300	60	300	-	-	3,520	1	✓	piece			
HD	-	KR 60*400	60	400	-	-	4,610	1	✓	piece			
HD	-	KR 60*500	60	500	-	-	5,320	1	✓	piece			
HD	-	KR 60*600	60	600	-	-	6,160	1	✓	piece			

To fix with:

HD	-	VM 6*10	-	-	M6	10	0,010	250	✓	piece			
HD	-	VMK 6*10	-	-	M6	-	0,010	250	✓	piece			

Minimum number bolts and nuts VM 6*10: 16 pieces.

Accessories

DKR

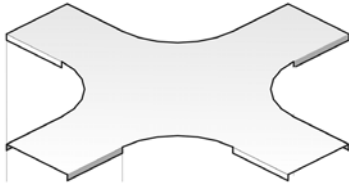
Cover for cross-over

For all heights

On Demand	Powder coating / Duplex System
Standard finish	Pre-galvanised
Optional finish 1	Hot-dip galvanised

1		Reference	Height	Width	Thickness	Length	kg/piece	Packaging	Stock	Unit			
HD	-	DKR 050	-	50	-	-	0,450	1	✓	piece			
HD	-	DKR 075	-	75	-	-	0,700	1	✓	piece			
HD	-	DKR 100	-	100	-	-	0,770	1	✓	piece			
HD	-	DKR 150	-	150	-	-	1,160	1	✓	piece			
HD	-	DKR 200	-	200	-	-	1,590	1	✓	piece			
HD	-	DKR 250	-	250	-	-	2,020	1	✓	piece			
HD	-	DKR 300	-	300	-	-	2,480	1	✓	piece			
HD	-	DKR 400	-	400	-	-	5,000	1	✓	piece			
HD	-	DKR 500	-	500	-	-	6,700	1	✓	piece			
HD	-	DKR 600	-	600	-	-	8,300	1	✓	piece			

To fix with:

-	-	DCL	-	-	-	-	0,005	96	✓	piece			
---	---	-----	---	---	---	---	-------	----	---	-------	--	--	--

SB 90

Rising elbow 90°

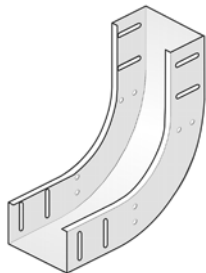

Slides over the cable trays

Radius	100 mm
On Demand	Height 35 mm - 85 mm - 110 mm
On Demand	Powder coating / Duplex System
Standard finish	Pre-galvanised
Optional finish 1	Hot-dip galvanised

1		Reference	Height	Width	Thickness	Length	kg/piece	Packaging	Stock	Unit			
HD	-	SB 90*60*050	60	50	-	-	0,550	1	✓	piece			
HD	-	SB 90*60*075	60	75	-	-	0,650	1	✓	piece			
HD	-	SB 90*60*100	60	100	-	-	0,730	1	✓	piece			
HD	-	SB 90*60*150	60	150	-	-	0,880	1	✓	piece			
HD	-	SB 90*60*200	60	200	-	-	1,000	1	✓	piece			
HD	-	SB 90*60*250	60	250	-	-	1,080	1	✓	piece			
HD	-	SB 90*60*300	60	300	-	-	1,180	1	✓	piece			
HD	-	SB 90*60*400	60	400	-	-	1,430	1	✓	piece			
HD	-	SB 90*60*500	60	500	-	-	1,900	1	✓	piece			
HD	-	SB 90*60*600	60	600	-	-	2,150	1	✓	piece			

To fix with:

HD	-	VM 6*10	-	-	M6	10	0,010	250	✓	piece			
HD	-	VMK 6*10	-	-	M6	-	0,010	250	✓	piece			

Minimum number bolts and nuts VM 6*10: 8 pieces.

Accessories

SBCL

Snap-in internal rising bend 90°

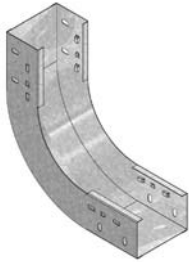

Snap-in system with cable tray KBS 60 and KBSI 60

Radius	100 mm
On Demand	Powder coating / Duplex System
Standard finish	Pre-galvanised

1	Reference	Height	Width	Thickness	Length	kg/piece	Packaging	Stock	Unit
-	SBCL 90°60*050	60	50	-	-	0,550	1	✓	piece
-	SBCL 90°60*075	60	75	-	-	0,650	1	✓	piece
-	SBCL 90°60*100	60	100	-	-	0,730	1	✓	piece
-	SBCL 90°60*150	60	150	-	-	0,880	1	✓	piece
-	SBCL 90°60*200	60	200	-	-	1,000	1	✓	piece
-	SBCL 90°60*250	60	250	-	-	1,080	1	✓	piece
-	SBCL 90°60*300	60	300	-	-	1,180	1	✓	piece
-	SBCL 90°60*400	60	400	-	-	1,430	1	✓	piece
-	SBCL 90°60*500	60	500	-	-	1,900	1	✓	piece
-	SBCL 90°60*600	60	600	-	-	2,150	1	✓	piece

- pening for extra locking using 4x VM 6*10
- openings provided for fitting a lid
- Only available in height 60 mm.

DSB 90

Cover for rising elbow 90°

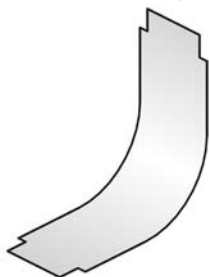

Flat banded.

On Demand	Powder coating / Duplex System
Standard finish	Pre-galvanised
Optional finish 1	Hot-dip galvanised

1	Reference	Height	Width	Thickness	Length	kg/piece	Packaging	Stock	Unit
HD	DSB 90°050	-	50	-	-	0,150	1	✓	piece
HD	DSB 90°075	-	75	-	-	0,180	1	✓	piece
HD	DSB 90°100	-	100	-	-	0,250	1	✓	piece
HD	DSB 90°150	-	150	-	-	0,360	1	✓	piece
HD	DSB 90°200	-	200	-	-	0,510	1	✓	piece
HD	DSB 90°250	-	250	-	-	0,600	1	✓	piece
HD	DSB 90°300	-	300	-	-	0,730	1	✓	piece
HD	DSB 90°400	-	400	-	-	1,020	1	✓	piece
HD	DSB 90°500	-	500	-	-	1,050	1	✓	piece
HD	DSB 90°600	-	600	-	-	1,430	1	✓	piece

To fix with:

-	DCL	-	-	-	-	0,005	96	✓	piece
---	-----	---	---	---	---	-------	----	---	-------

VB 90

Low elbow 90°

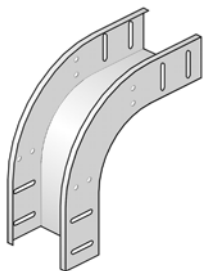

Slides over the cable trays

Radius	100 mm
On Demand	Height 35 mm - 85 mm - 110 mm
On Demand	Powder coating / Duplex System
Standard finish	Pre-galvanised
Optional finish 1	Hot-dip galvanised

1		Reference	Height	Width	Thickness	Length	kg/piece	Packaging	Stock	Unit			
HD	-	VB 90*60*050	60	50	-	-	0,550	1	✓	piece			
HD	-	VB 90*60*075	60	75	-	-	0,630	1	✓	piece			
HD	-	VB 90*60*100	60	100	-	-	0,650	1	✓	piece			
HD	-	VB 90*60*150	60	150	-	-	0,780	1	✓	piece			
HD	-	VB 90*60*200	60	200	-	-	0,850	1	✓	piece			
HD	-	VB 90*60*250	60	250	-	-	0,950	1	✓	piece			
HD	-	VB 90*60*300	60	300	-	-	1,080	1	✓	piece			
HD	-	VB 90*60*400	60	400	-	-	1,330	1	✓	piece			
HD	-	VB 90*60*500	60	500	-	-	1,430	1	✓	piece			
HD	-	VB 90*60*600	60	600	-	-	1,600	1	✓	piece			

To fix with:

HD	-	VM 6*10	-	-	M6	10	0,010	250	✓	piece			
HD	-	VMK 6*10	-	-	M6	-	0,010	250	✓	piece			

Minimum number bolts and nuts VM 6*10: 8 pieces.

Accessories

VBCL

Snap-in external rising bend

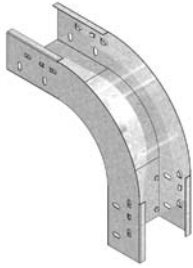

Snap-in system with cable tray KBS 60 and KBSI 60

Radius	100 mm
On Demand	Powder coating / Duplex System
Standard finish	Pre-galvanised

1	Reference	Height	Width	Thickness	Length	kg/piece	Packaging	Stock	Unit
-	VBCL 90°60*050	60	50	-	-	0,550	1	✓	piece
-	VBCL 90°60*075	60	75	-	-	0,630	1	✓	piece
-	VBCL 90°60*100	60	100	-	-	0,650	1	✓	piece
-	VBCL 90°60*150	60	150	-	-	0,780	1	✓	piece
-	VBCL 90°60*200	60	200	-	-	0,850	1	✓	piece
-	VBCL 90°60*250	60	250	-	-	0,950	1	✓	piece
-	VBCL 90°60*300	60	300	-	-	1,080	1	✓	piece
-	VBCL 90°60*400	60	400	-	-	1,330	1	✓	piece
-	VBCL 90°60*500	60	500	-	-	1,430	1	✓	piece
-	VBCL 90°60*600	60	600	-	-	1,600	1	✓	piece

- opening for extra locking using 4x VM 6*10
- openings provided for fitting a lid.
- Only available in height 60 mm.

DVB 90

Cover for low elbow 90°

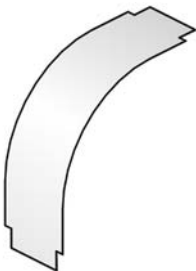

Flat banded

On Demand	Height of 35 mm - 85 mm - 110 mm
On Demand	Powder coating / Duplex System
Standard finish	Pre-galvanised
Optional finish 1	Hot-dip galvanised

1	Reference	Height	Width	Thickness	Length	kg/piece	Packaging	Stock	Unit
HD	DVB 90°60*050	-	50	-	-	0,150	1	✓	piece
HD	DVB 90°60*075	-	75	-	-	0,220	1	✓	piece
HD	DVB 90°60*100	-	100	-	-	0,320	1	✓	piece
HD	DVB 90°60*150	-	150	-	-	0,480	1	✓	piece
HD	DVB 90°60*200	-	200	-	-	0,630	1	✓	piece
HD	DVB 90°60*250	-	250	-	-	0,680	1	✓	piece
HD	DVB 90°60*300	-	300	-	-	0,960	1	✓	piece
HD	DVB 90°60*400	-	400	-	-	1,270	1	✓	piece
HD	DVB 90°60*500	-	500	-	-	1,400	1	✓	piece
HD	DVB 90°60*600	-	600	-	-	1,740	1	✓	piece

To fix with:

-	DCL	-	-	-	-	0,005	96	✓	piece
---	-----	---	---	---	---	-------	----	---	-------

SDB

Hinged joint double

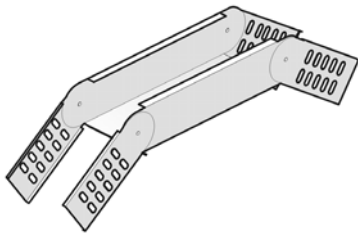

On Demand	Height 35 mm - 85 mm - 110 mm
On Demand	Powder coating / Duplex System
Standard finish	Pre-galvanised
Optional finish 1	Hot-dip galvanised

1		Reference	Height	Width	Thickness	Length	kg/piece	Packaging	Stock	Unit			
HD	-	SDB 60*050	60	50	-	-	0,700	1	-	piece			
HD	-	SDB 60*075	60	75	-	-	0,750	1	-	piece			
HD	-	SDB 60*100	60	100	-	-	0,800	1	-	piece			
HD	-	SDB 60*150	60	150	-	-	0,900	1	-	piece			
HD	-	SDB 60*200	60	200	-	-	0,950	1	-	piece			
HD	-	SDB 60*250	60	250	-	-	1,050	1	-	piece			
HD	-	SDB 60*300	60	300	-	-	1,150	1	-	piece			
HD	-	SDB 60*400	60	400	-	-	1,350	1	-	piece			
HD	-	SDB 60*500	60	500	-	-	1,750	1	-	piece			
HD	-	SDB 60*600	60	600	-	-	2,050	1	-	piece			

To fix with:

HD	-	VM 6*10	-	-	M6	10	0,010	250	✓	piece			
HD	-	VMK 6*10	-	-	M6	-	0,010	250	✓	piece			

Minimum number bolts and nuts VM 6*10: 8 pieces.

DS

Hinged joint

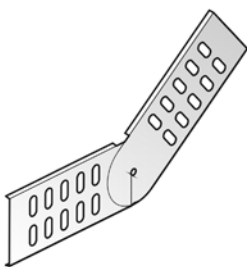

On Demand	Powder coating / Duplex System
Standard finish	Pre-galvanised
Optional finish 1	Hot-dip galvanised

1		Reference	Height	Width	Thickness	Length	kg/piece	Packaging	Stock	Unit			
HD	-	DS 35	35	-	-	-	0,110	24	-	piece			
HD	-	DS 60	60	-	-	-	0,130	50	✓	piece			
HD	-	DS 85	85	-	-	-	0,340	24	-	piece			
HD	-	DS 110	110	-	-	-	0,390	24	-	piece			

Minimum number bolts and nuts VM 6*10: 4 pieces.

Accessories

AZH

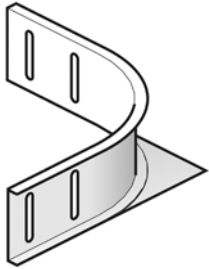
Universal coupling 90°

On Demand	Powder coating / Duplex System
Standard finish	Pre-galvanised
Optional finish 1	Hot-dip galvanised

1		Reference	Height	Width	Thickness	Length	kg/piece	Packaging	Stock	Unit			
HD	-	AZH 35	35	-	-	-	0,340	1	-	piece			
HD	-	AZH 60	60	-	-	-	0,390	1	✓	piece			
HD	-	AZH 85	85	-	-	-	0,750	1	-	piece			
HD	-	AZH 110	110	-	-	-	0,900	1	-	piece			

To fix with:

HD	-	VM 6*10	-	-	M6	10	0,010	250	✓	piece			
HD	-	VMK 6*10	-	-	M6	-	0,010	250	✓	piece			

Minimum number bolts and nuts VM 6*10: 4 pieces.

BVSI

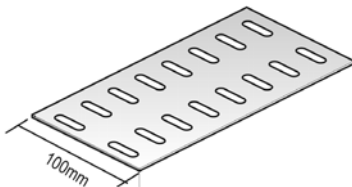
Stiffening plate

On Demand	Powder coating / Duplex System
Standard finish	Pre-galvanised
Optional finish 1	Hot-dip galvanised

1		Reference	Height	Width	Thickness	Length	kg/piece	Packaging	Stock	Unit			
HD	-	BVSI 050	-	46,6	-	-	0,080	1	✓	piece			
HD	-	BVSI 075	-	70	-	-	0,100	1	✓	piece			
HD	-	BVSI 100	-	75	-	-	0,100	1	✓	piece			
HD	-	BVSI 150	-	125	-	-	0,160	1	✓	piece			
HD	-	BVSI 200	-	175	-	-	0,180	1	✓	piece			
HD	-	BVSI 250	-	225	-	-	0,300	1	✓	piece			
HD	-	BVSI 300	-	275	-	-	0,370	1	✓	piece			
HD	-	BVSI 400	-	375	-	-	0,500	1	✓	piece			
HD	-	BVSI 500	-	475	-	-	0,520	1	✓	piece			
HD	-	BVSI 600	-	575	-	-	0,750	1	✓	piece			

To fix with:

HD	-	VM 6*10	-	-	M6	10	0,010	250	✓	piece			
HD	-	VMK 6*10	-	-	M6	-	0,010	250	✓	piece			

Minimum number bolts and nuts VM 6*10: 4 pieces.

VS

Reducing plate

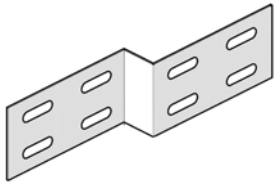

On Demand	Height 35 mm - 85 mm - 110 mm
On Demand	Powder coating / Duplex System
Standard finish	Pre-galvanised
Optional finish 1	Hot-dip galvanised

1		Reference	Height	Width	Thickness	Length	kg/piece	Packaging	Stock	Unit			
HD	-	VS 60*025	60	25	-	-	0,080	1	✓	piece			
HD	-	VS 60*050	60	50	-	-	0,080	1	✓	piece			
HD	-	VS 60*075	60	75	-	-	0,090	1	✓	piece			
HD	-	VS 60*100	60	100	-	-	0,100	1	✓	piece			
HD	-	VS 60*125	60	125	-	-	0,100	1	✓	piece			
HD	-	VS 60*150	60	150	-	-	0,110	1	✓	piece			
HD	-	VS 60*200	60	200	-	-	0,120	1	✓	piece			
HD	-	VS 60*250	60	250	-	-	0,140	1	✓	piece			
HD	-	VS 60*300	60	300	-	-	0,180	1	✓	piece			
HD	-	VS 60*350	60	350	-	-	0,180	1	✓	piece			
HD	-	VS 60*400	60	400	-	-	0,210	1	✓	piece			

To fix with:

HD	-	VM 6*10	-	-	M6	10	0,010	250	✓	piece			
HD	-	VMK 6*10	-	-	M6	-	0,010	250	✓	piece			

More technical specifications for this product can be found at the end of this chapter.

Minimum number bolts and nuts VM 6*10: 4 pieces.

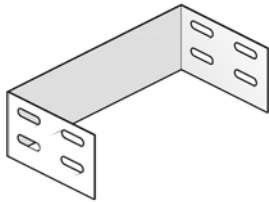
Accessories
E
End piece

On Demand	Height 35 mm - 85 mm - 110 mm
On Demand	Powder coating / Duplex System
Standard finish	Pre-galvanised
Optional finish 1	Hot-dip galvanised

1		Reference	Height	Width	Thickness	Length	kg/piece	Packaging	Stock	Unit			
HD	-	E 60*050	60	50	-	-	0,090	1	✓	piece			
HD	-	E 60*075	60	75	-	-	0,100	1	✓	piece			
HD	-	E 60*100	60	100	-	-	0,110	1	✓	piece			
HD	-	E 60*150	60	150	-	-	0,130	1	✓	piece			
HD	-	E 60*200	60	200	-	-	0,150	1	✓	piece			
HD	-	E 60*250	60	250	-	-	0,170	1	✓	piece			
HD	-	E 60*300	60	300	-	-	0,180	1	✓	piece			
HD	-	E 60*400	60	400	-	-	0,220	1	✓	piece			
HD	-	E 60*500	60	500	-	-	0,360	1	✓	piece			
HD	-	E 60*600	60	600	-	-	0,410	1	✓	piece			
To fix with:													
HD	-	VM 6*10	-	-	M6	10	0,010	250	✓	piece			
HD	-	VMK 6*10	-	-	M6	-	0,010	250	✓	piece			

Minimum number bolts and nuts VM 6*10: 4 pieces.

MP

Folded mounting plate

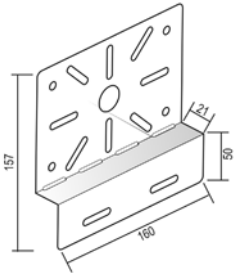

On Demand	Powder coating / Duplex System
Standard finish	Pre-galvanised
Optional finish 1	Hot-dip galvanised

1		Reference	Height	Width	Thickness	Length	kg/piece	Packaging	Stock	Unit			
HD	-	MP	-	-	-	-	0,180	50	✓	piece			
To fix with:													
HD	-	VM 6*10	-	-	M6	10	0,010	250	✓	piece			
HD	-	VMK 6*10	-	-	M6	-	0,010	250	✓	piece			

For fixation of the contact and distribution boxes inside the cable tray.
Number bolts and nuts VM 6*10: 2 pieces.

MPV

Flat mounting plate

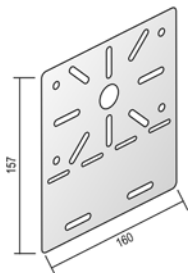

For the fixation of contact and distribution boxes

On Demand	Powder coating / Duplex System
Standard finish	Pre-galvanised
Optional finish 1	Hot-dip galvanised

1		Reference	Height	Width	Thickness	Length	kg/piece	Packaging	Stock	Unit			
HD	-	MPV	-	-	-	-	0,200	50	✓	piece			
To fix with:													
HD	-	VM 6*10	-	-	M6	10	0,010	250	✓	piece			
-	-	KBV	-	-	-	-	0,010	96	✓	piece			
HD	-	VMK 6*10	-	-	M6	-	0,010	250	✓	piece			

Number bolts and nuts VM 6*10: 2 pieces.

Accessories

MPVCL

Mounting plate clips

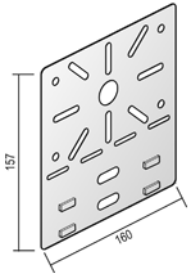

For the fixation of contact and distribution boxes.

On Demand	Powder coating / Duplex System
Standard finish	Pre-galvanised

1	Reference	Height	Width	Thickness	Length	kg/piece	Packaging	Stock	Unit			
-	- MPVCL	-	-	-	-	0,180	50	✓	piece			

Clippable on the perforated cable tray with clip KBV.

SLOS

Division plate free

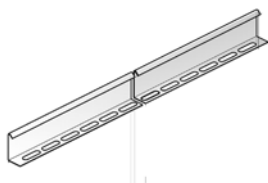

On Demand	Powder coating / Duplex System
Standard finish	Pre-galvanised
Optional finish 1	Hot-dip galvanised

1		Reference	Height	Width	Thickness	Length	kg/m	Packaging	Stock	Unit			
HD	-	SLOS 35	35	-	-	3000	0,330	150	✓	m			
HD	-	SLOS 60	60	-	-	3000	0,510	120	✓	m			
HD	-	SLOS 85	85	-	-	3000	0,680	60	✓	m			
HD	-	SLOS 110	110	-	-	3000	0,820	3	✓	m			

To fix with:													
HD	-	VM 6*10	-	-	M6	10	0,010	250	✓	piece			
HD	-	VMK 6*10	-	-	M6	-	0,010	250	✓	piece			

Fixation set VM 6*10: 1 per meter.

SLIS

Clip-in partition

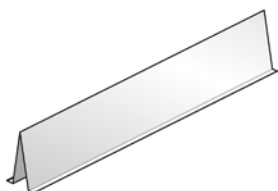

Standard finish	Pre-galvanised
-----------------	----------------

1		Reference	Height	Width	Thickness	Length	kg/m	Packaging	Stock	Unit			
-	-	SLIS 60	60	-	-	3000	0,440	3	✓	m			

Fixation set clips CL : 4 pieces per length.
Separation SLIS can be used on any width from 200 mm.

Accessories

CL

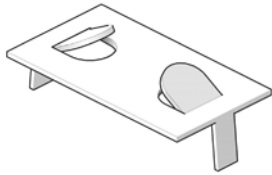
Clips for clip-in partition

Standard finish

Pre-galvanised

1	Reference	Height	Width	Thickness	Length	kg/piece	Packaging	Stock	Unit			
-	- CL	-	-	-	-	0,005	100	✓	piece			

4 pieces per length

SIN

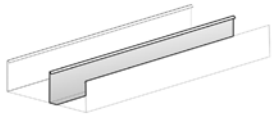
Build-in division plate

On Demand

Powder coating / Duplex System

Standard finish

Pre-galvanised

Optional finish 1

Hot-dip galvanised

1	Reference	Height	Width	Thickness	Length	kg/m	Packaging	Stock	Unit			
HD	- SIN 60	60	-	-	3000	0,520	3	-	m			
HD	- SIN 85	85	-	-	3000	0,670	3	-	m			
HD	- SIN 110	110	-	-	3000	0,900	3	-	m			

This partition is pointwelded in the cable tray KG according to your specifications.
The scale should be given when ordering.

V 35

Jointing plate for fast mounting

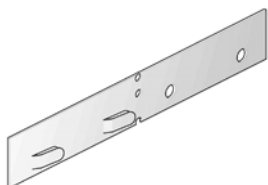

On Demand	Powder coating / Duplex System
Standard finish	Pre-galvanised

1	Reference	Height	Width	Thickness	Length	kg/piece	Packaging	Stock	Unit
-	V 35	35	-	-	-	0,050	48	✓	piece

Minimum number bolts and nuts VM 6*10: 1 pieces.

V 60

Jointing plate for fast mounting

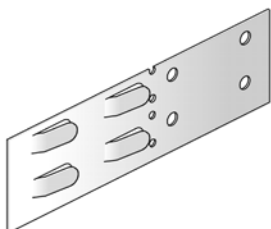

On Demand	Powder coating / Duplex System
Standard finish	Pre-galvanised

1	Reference	Height	Width	Thickness	Length	kg/piece	Packaging	Stock	Unit
-	V 60	60	-	-	-	0,090	48	✓	piece

Minimum number bolts and nuts VM 6*10: 2 pieces.

V 85

Jointing plate for fast mounting

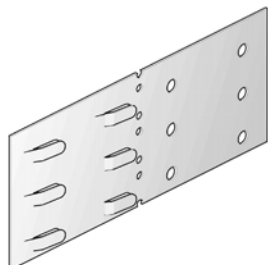

On Demand	Powder coating / Duplex System
Standard finish	Pre-galvanised

1	Reference	Height	Width	Thickness	Length	kg/piece	Packaging	Stock	Unit
-	V 85	85	-	-	-	0,130	48	✓	piece

Minimum number bolts and nuts VM 6*10: 2 pieces.

Accessories

V 15*200

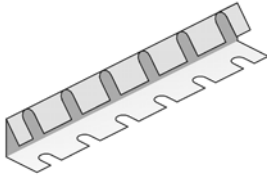
Jointing plate

On Demand	Powder coating / Duplex System
Standard finish	Pre-galvanised
Optional finish 1	Hot-dip galvanised

1	Reference	Height	Width	Thickness	Length	kg/piece	Packaging	Stock	Unit			
HD	- V 15*200	15	200	-	-	0,050	48	✓	piece			

V 35*200

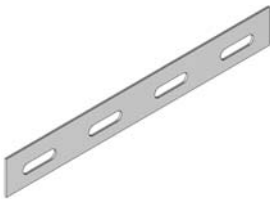
Jointing plate

On Demand	Powder coating / Duplex System
Standard finish	Pre-galvanised
Optional finish 1	Hot-dip galvanised

1	Reference	Height	Width	Thickness	Length	kg/piece	Packaging	Stock	Unit			
HD	- V 35*200	35	200	-	-	0,040	48	✓	piece			

Minimum number bolts and nuts VM 6*10: 2 pieces.

V 60*200

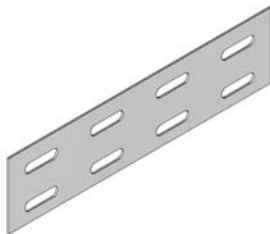
Jointing plate

On Demand	Powder coating / Duplex System
Standard finish	Pre-galvanised
Optional finish 1	Hot-dip galvanised

1	Reference	Height	Width	Thickness	Length	kg/piece	Packaging	Stock	Unit			
HD	- V 60*200	60	200	-	-	0,080	48	✓	piece			

Minimum number bolts and nuts VM 6*10: 4 pieces.

V 85*200

Jointing plate

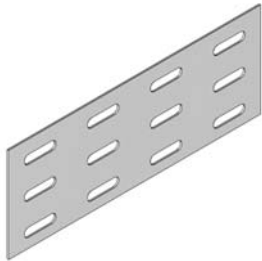

On Demand	Powder coating / Duplex System
Standard finish	Pre-galvanised
Optional finish 1	Hot-dip galvanised

1		Reference	Height	Width	Thickness	Length	kg/piece	Packaging	Stock	Unit			
HD	-	V 85*200	85	200	-	-	0,130	48	✓	piece			

Minimum number bolts and nuts VM 6*10: 4 pieces.

V 110*200

Jointing plate

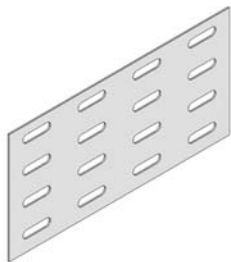

On Demand	Powder coating / Duplex System
Standard finish	Pre-galvanised
Optional finish 1	Hot-dip galvanised

1		Reference	Height	Width	Thickness	Length	kg/piece	Packaging	Stock	Unit			
HD	-	V 110*200	110	200	-	-	0,170	48	✓	piece			

Minimum number bolts and nuts VM 6*10: 8 pieces.

KPW

Jointing plate for wide-span

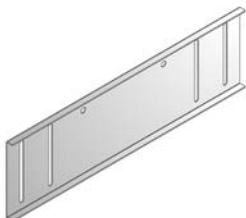

On Demand	Powder coating / Duplex System
Standard finish	Pre-galvanised
Optional finish 1	Hot-dip galvanised

1		Reference	Height	Width	Thickness	Length	kg/piece	Packaging	Stock	Unit			
HD	-	KPW	110	-	-	-	0,590	24	✓	piece			

Minimum number bolts and nuts VM 6*10: 8 pieces.

Accessories

LV

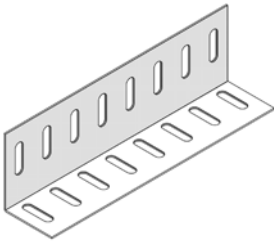
Supporting corner

On Demand	Powder coating / Duplex System
Standard finish	Pre-galvanised
Optional finish 1	Hot-dip galvanised

1		Reference	Height	Width	Thickness	Length	kg/piece	Packaging	Stock	Unit			
HD	-	LV 35	35	-	-	-	0,080	24	-	piece			
HD	-	LV 60*85	60-85	-	-	-	0,170	24	✓	piece			
HD	-	LV 110	110	-	-	-	0,240	24	-	piece			

Minimum number bolts and nuts VM 6*10: 4 pieces.

KBV

Fast locking for KBSI

Standard finish	Stainless Steel
-----------------	-----------------

1		Reference	Height	Width	Thickness	Length	kg/piece	Packaging	Stock	Unit			
-	-	KBV	-	-	-	-	0,010	96	✓	piece			

KBSI 35

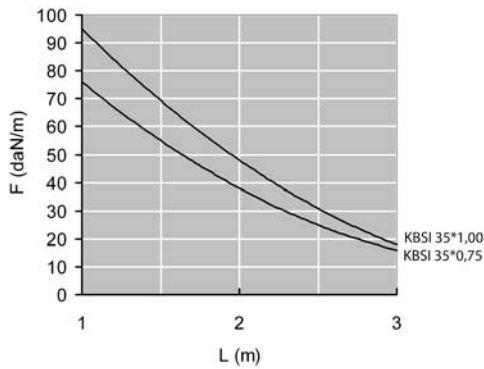

LOAD DIAGRAM

Graph valid for KBSI 35. This diagram illustrates the permissible uniformly distributed loads applied to multiple supports. They comply with IEC 61537 par 10.3.3 test type III with connection to 1/5 of the span.

F = max. admissible load (daN/m)
L = support distance (m)

Max. deflection (m) = L/100

KBSI 60

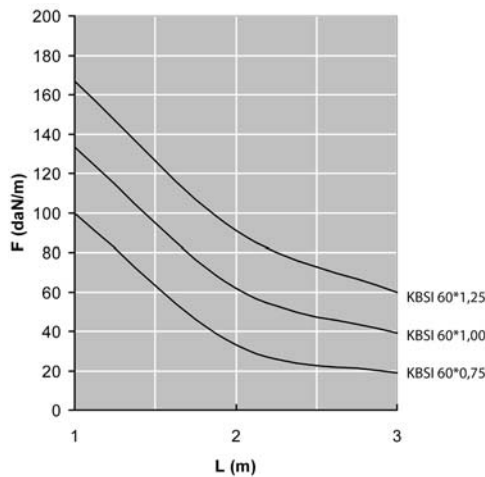

LOAD DIAGRAM

Graph valid for KBSI 60. This diagram illustrates the permissible uniformly distributed loads applied to multiple supports. They comply with IEC 61537 par 10.3.3 test type III with connection to 1/5 of the span.

F = max. admissible load (daN/m)
L = support distance (m)

Max. deflection (m) = L/100

KBSI 60*6

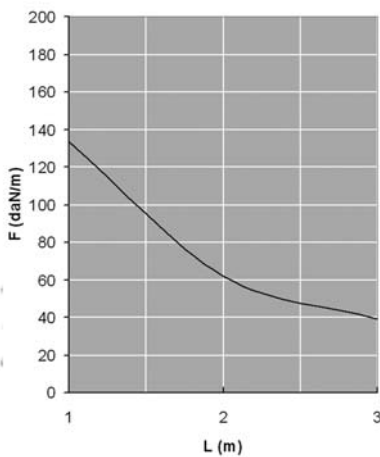

LOAD DIAGRAM

Graph valid for KBSI 60*6. This diagram illustrates the permissible uniformly distributed loads applied to multiple supports. They comply with IEC 61537 par 10.3.3 test type III with connection to 1/5 of the span.

F = max. admissible load (daN/m)
L = support distance (m)

Max. deflection (m) = L/100

KBS 35

LOAD DIAGRAM

Graph valid for KBS 35. This diagram illustrates the permissible uniformly distributed loads applied to multiple supports. They comply with IEC 61537 par 10.3.3 test type III with connection to 1/5 of the span.

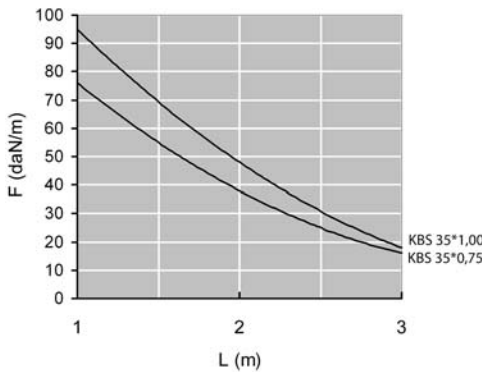

F = max. admissible load (daN/m)

L = support distance (m)

Max. deflection (m) = L/100

KBS 60

LOAD DIAGRAM

Graph valid for KBS 35. This diagram illustrates the permissible uniformly distributed loads applied to multiple supports. They comply with IEC 61537 par 10.3.3 test type III with connection to 1/5 of the span.

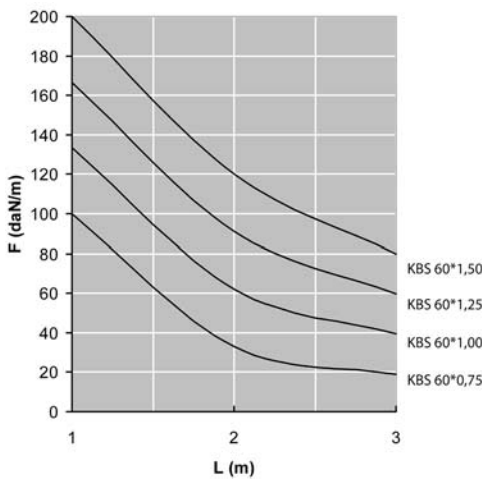

F = max. admissible load (daN/m)

L = support distance (m)

Max. deflection (m) = L/100

KBS 85

LOAD DIAGRAM

Graph valid for KBS 85. This diagram illustrates the permissible uniformly distributed loads applied to multiple supports. They comply with IEC 61537 par 10.3.3 test type III with connection to 1/5 of the span.

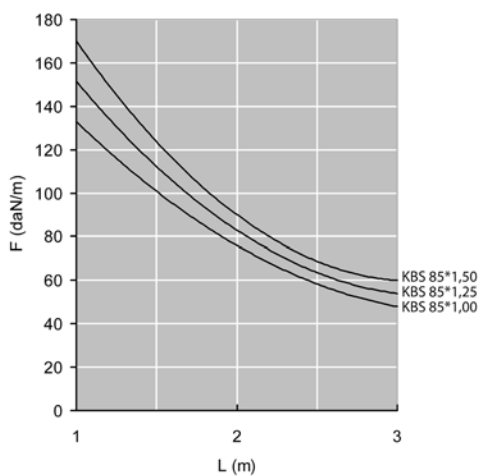

F = max. admissible load (daN/m)

L = support distance (m)

Max. deflection (m) = L/100

KBS 110

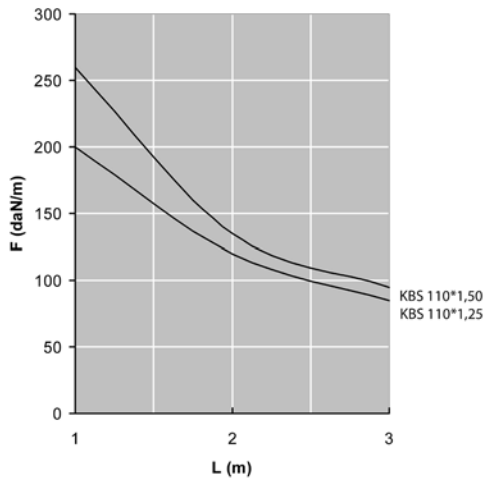

LOAD DIAGRAM

Graph valid for KBS 110. This diagram illustrates the permissible uniformly distributed loads applied to multiple supports. They comply with IEC 61537 par 10.3.3 test type III with connection to 1/5 of the span.

F = max. admissible load (daN/m)

L = support distance (m)

Max. deflection (m) = L/100

KBS 110*6

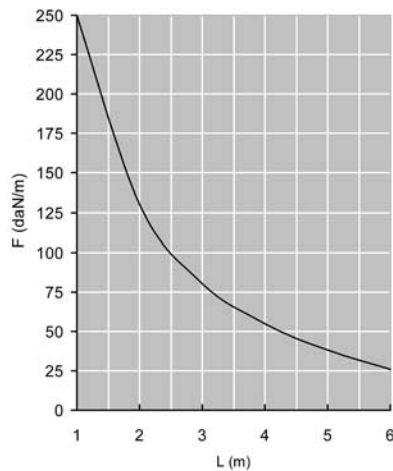

LOAD DIAGRAM

Graph valid for KBS 110*6. This diagram illustrates the permissible uniformly distributed loads applied to multiple supports. They comply with IEC 61537 par 10.3.3 test type III with connection to 1/5 of the span.

F = max. admissible load (daN/m)

L = support distance (m)

Max. deflection (m) = L/100

KGI 60

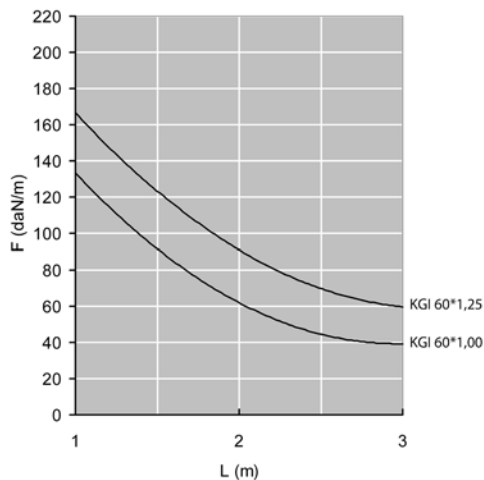

LOAD DIAGRAM

Graph valid for KGI 60. This diagram illustrates the permissible uniformly distributed loads applied to multiple supports. They comply with IEC 61537 par 10.3.3 test type III with connection to 1/5 of the span.

F = max. admissible load (daN/m)

L = support distance (m)

Max. deflection (m) = L/100

KG 110

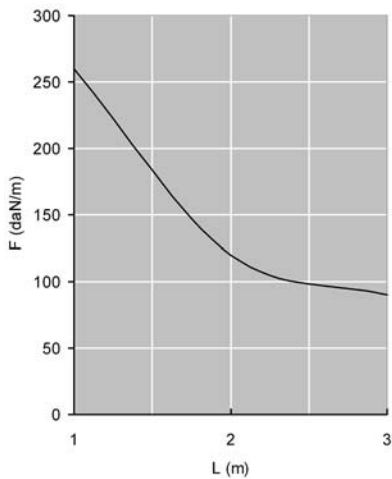

LOAD DIAGRAM

Graph valid for KG 110. This diagram illustrates the permissible uniformly distributed loads applied to multiple supports. They comply with IEC 61537 par 10.3.3 test type III with connection to 1/5 of the span.

F = max. admissible load (daN/m)

L = support distance (m)

Max. deflection (m) = L/100

NATO 15

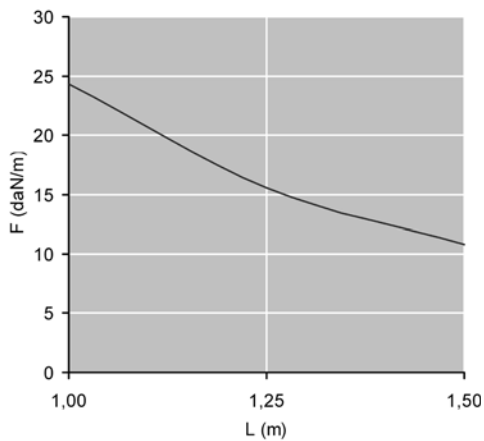

LOAD DIAGRAM

Graph valid for NATO 15, mounted in continuous span with the jointing plates 1/5 away from the supports. Safety factor = 2.

F = max. admissible load (daN/m)

L = support distance (m)

L/200 = deflection (m)

KBSI 60

Mounting principle

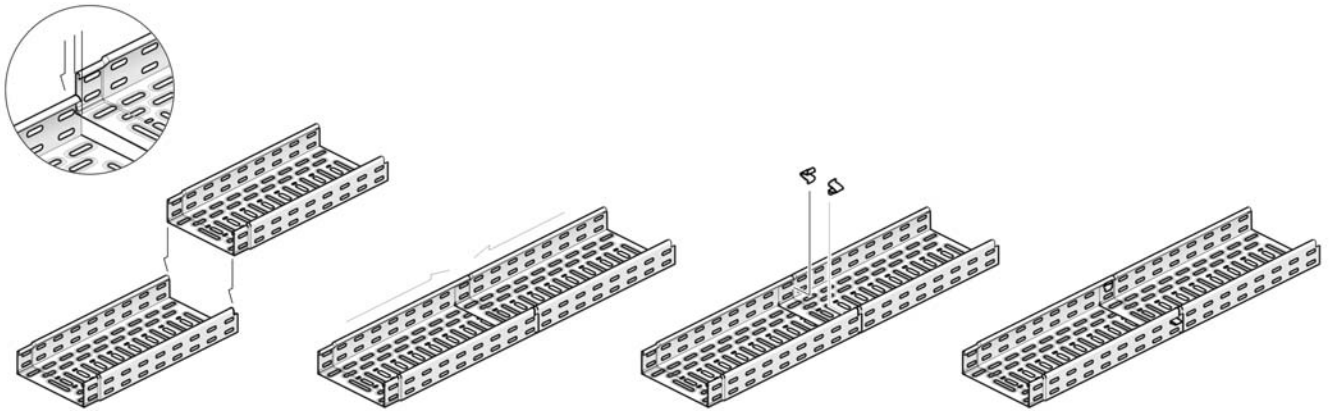

How do you proceed ?

Very simple :

1. Put two lengths together.
2. Slide them into each other.
3. Fix clips KBV for extra stability and safe locking.
4. Finished !!!

This system offers you various advantages :

1. Smaller cost price.
2. Faster mounting.
3. No bolts and nuts required.
4. Fixation with clips.
5. Earthing.
6. Easier fixation thanks to alternative perforations.
7. Better stability thanks to embedded perforations.
8. Better aeration of the cables thanks to embedded perforations.
9. Integrated cable protection thanks to overlapping ends.
10. Smooth finishing touch.
11. Smaller stock investment.

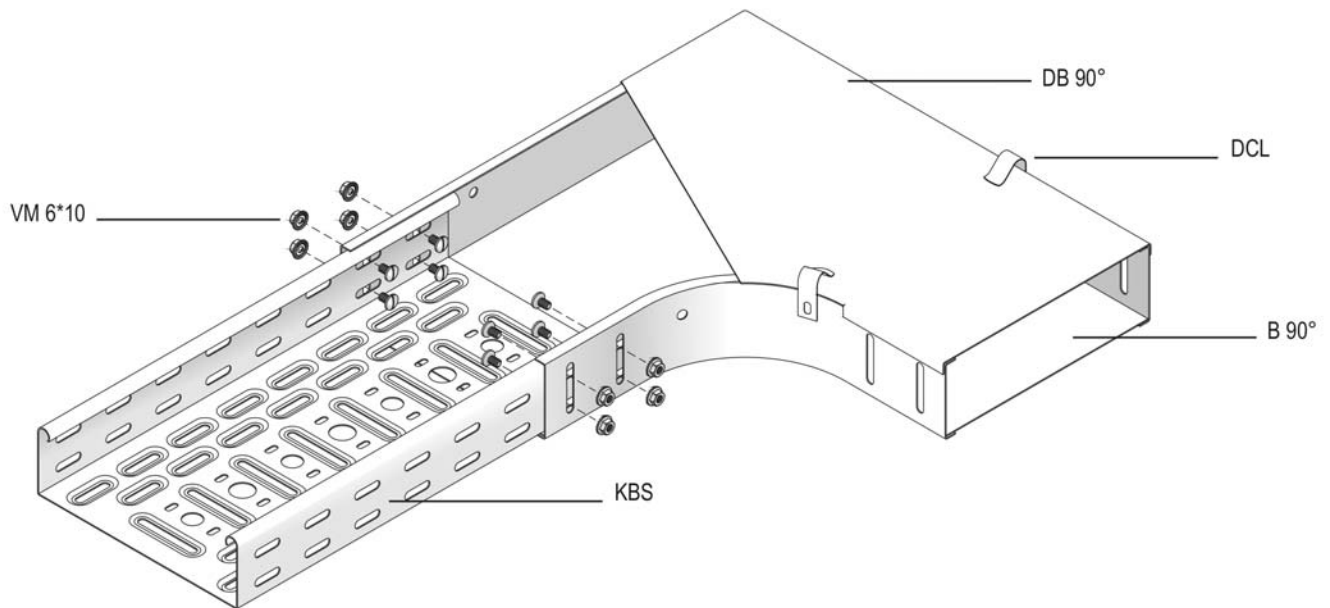
B 90**Mounting principle**

VS

Mounting principle

