

KLMZWBK

Bracket clamp

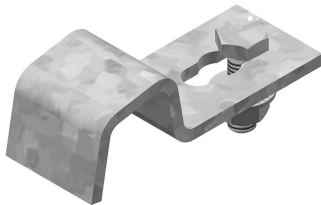

For fixing cable ladder to a wall bracket.

2 pieces per bracket.

Standard finish	Pre-galvanised
Optional finish	Hot-dip galvanised
Optional finish	Coating

HD	Reference	↑ mm	↔ mm	≡ mm	↔ mm	kg /stk		Stock	Unit
HD	KLMZWBK25	20	25			0,051	20	v	STK
HD	KLMZWBK40	20	40			0,125	20	v	STK

To order per full packaging.

KLMZWBK25: Bolt B6.20 and nuts RM6 included.

KLMZWBK40: Bolt B8.20 and nuts PNP08 included.

- 25 for cantilevers
- 40 for profiles 41