

KLMZWBK

Bracket clamp

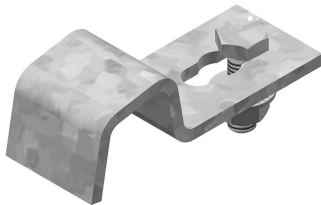

For fixing cable ladder to a wall bracket.

2 pieces per bracket.

| | |
|-----------------|--------------------|
| Standard finish | Pre-galvanised |
| Optional finish | Hot-dip galvanised |
| Optional finish | Coating |

| HD | Reference | ↑ mm | ↔ mm | ≡ mm | ↔ mm | kg /stk |  | Stock | Unit |
|----|-----------|---------|---------|---------|---------|------------|---|-------|------|
| HD | KLMZWBK25 | 20 | 25 | | | 0,051 | 20 | v | STK |
| HD | KLMZWBK40 | 20 | 40 | | | 0,125 | 20 | v | STK |

To order per full packaging.

KLMZWBK25: Bolt B6.20 and nuts RM6 included.

KLMZWBK40: Bolt B8.20 and nuts PNP08 included.

- 25 for cantilevers
- 40 for profiles 41