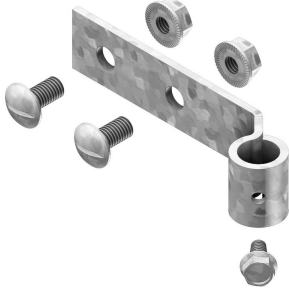

HDBSKLEM**Clamp for fixing of threaded rod (BS)**

Very fast securing of the threaded rod TIM, using a clamping bolt.
Applicable on HDWK and KCLBS.

Standard finish

Hot-dip galvanised

HD	Reference	↑ mm	← mm	≡ mm	↔ mm	kg /stk		Stock	Unit
-	HDBSKLEM	25	125			0,120	20	v	STK

To order per full packaging.
Ends held up through threaded rod TIM.
No additional bolts and nuts needed.
Threaded rod can be mounted in 1 continuous length.
Diameter of the threaded rod TIM not of influence.
Clamping bolt to be tightened with angular momentum of 10 Nm.