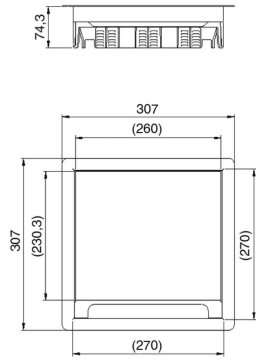

KDVIRK3**Hinged cover square, with border**

Build-in frame with border +
tileframe + cable outlet

Standard finish

Stainless Steel 304

HD	Reference	↑ mm	↔ mm	≡ mm	↔ mm	kg /stk		Stock	Unit
-	KDVIRK3		267		267	2,675	1	v	STK

Tested to EN 50085-2-2.

Hinged cover for 3 compartments.

Depth of floor covering can be reduced by fitting packers OHEV3.2 and/or OHEV3.5

Can be fixed through included universal clamps in raised floor panels.

- Cut-outs in the floor panels 270x270 mm (with a tolerance of -1 mm to +2 mm).
- Clamp range between 30 and 50 mm

Hinged cover is provided with 2 cable outlets with integrated push lever and cable organiser.

Hinged cover is provided with an earthing strip between cover and frame.

For use in dry floors only.