

LOMEGACLU150

Wall bracket universal

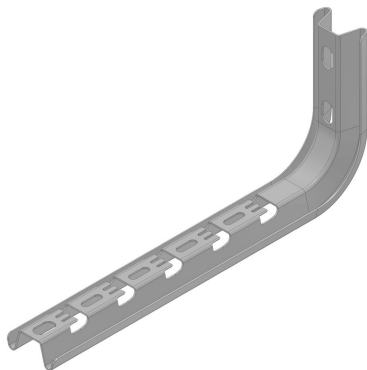

Standard finish	Pre-galvanised
Optional finish	Hot-dip galvanised
Optional finish	Coating

	Max. load (in daN)
LOMEGACLU150.100	110
LOMEGACLU150.150	100
LOMEGACLU150.200	90
LOMEGACLU150.250	80
LOMEGACLU150.300	70
LOMEGACLU150.400	50
LOMEGACLU150.500	40
LOMEGACLU150.600	30

HD	Reference	↑ mm	↔ mm	≡ mm	↔ mm	kg /stk	📦	Stock	Unit
HD	LOMEGACLU150.100	145	155			0,3	12	v	STK
HD	LOMEGACLU150.150	145	185			0,32	12	v	STK
HD	LOMEGACLU150.200	145	235			0,34	12	v	STK
HD	LOMEGACLU150.250	145	285			0,45	12	v	STK
HD	LOMEGACLU150.300	145	335			0,49	12	v	STK
HD	LOMEGACLU150.400	145	435			0,54	6	v	STK
HD	LOMEGACLU150.500	145	535			0,71	6	v	STK
HD	LOMEGACLU150.600	145	635			0,77	6	v	STK

To order per full packaging.

Fixing of the cable tray by VM6.20.

Use the VOMEGA to avoid compression of the profile.

Max. load (in daN): uniformly distributed over complete width of cantilever brackets.

Do not use with: VFUL30.065, VFUL35.150, VFU35.150, VFUL 60.050.