

OBG

Upper bracket

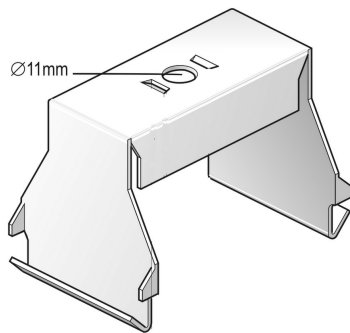

To mount cable trays with partition.

Standard finish	Pre-galvanised
Optional finish	Hot-dip galvanised
Optional finish	Coating

	Max. load (in daN)
OBG050	200
OBG075	200
OBG100	200
OBG150	200
OBG200	200
OBG250	150
OBG300	150
OBG400	90

HD	Reference	↑ mm	↔ mm	≡ mm	↔ mm	kg /stk		Stock	Unit
HD	OBG050	64	55			0,100	12 v		STK
HD	OBG075	64	80			0,130	12 v		STK
HD	OBG100	64	105			0,140	12 v		STK
HD	OBG150	64	155			0,190	12 v		STK
HD	OBG200	64	205			0,220	12 v		STK
HD	OBG250	64	255			0,270	12 v		STK
HD	OBG300	64	305			0,310	6 v		STK
HD	OBG400	64	405			0,390	6 v		STK

To order per full packaging.

To be mounted with threaded rod TIM8 or TIM10.