

# P1000TTT

## Assembly profile perforation on 3 sides

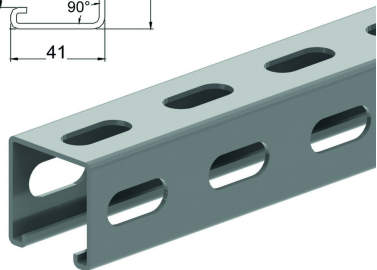
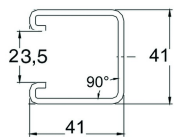

Reference	Finish	↑ mm	↔ mm	→  ← mm	↔ mm	kg/m	📦	Unit
<b>P1000TTTVP</b>	-	41	41	2,5	6000	2,315	300	M
<b>P1000TTTV</b>	ZP	41	41	2,5	6000	2,315	6	M
<b>P1000TTTVH</b>	HG	41	41	2,5	6000	2,430	6	M
<b>P1000TTTVX3</b>	ZP	41	41		3000	2,600	3	M
<b>P1000TTTVHX3</b>	HG	41	41		3000	2,600	3	M

Abbreviation:

- ZP = Zinc Plated
- HG = Hot-Dip Galvanised

### Legend finish

- ZP = Zinc plated
- HG = Hot-dip galvanised